

# FLEA RECESSED RGBW

FLEA is a family of IP67-rated round or square recessed wall / in-grade or downlights available in static white, RGBW, and and underwater version (IP68). FLEA Recessed RGBW is offered round (Ø2.0" or Ø1.8" Total Glass) or square (2.0" sq. or 2.1" sq. Total Glass) with RGBW light, 2 optics options, and 4 standard finishes.



FLEA Recessed Round Trim RGBW



FLEA Recessed Square Trim RGBW

Fixture Dimensions - See page 2

## TECHNICAL DATA

<b>Wattage</b>	8W
<b>Power Supply</b>	Remote 24VDC, not included. See page 2
<b>Construction</b>	Housing: Anticorodal Aluminum Lens: Extra Clear Tempered Glass
<b>CCT</b>	RGBW
<b>BUG Rating</b>	—
<b>Delivered Lumens</b>	211 lm: (R) 28 lm, (G) 70 lm, (B) 17 lm, (W) 96 lm (6500K)
<b>Efficacy</b>	26.4 lm/W: (R) 3.5 lm/W lm, (G) 8.8 lm/W, (B) 2.1 lm/W, (W) 12 lm (6500K)
<b>Optics</b>	30°, Diffuse
<b>Finishes</b>	Anodized Matte Black, Anodized Aluminum, AISI 316L Stainless Steel, Total Glass
<b>Lumen Maintenance</b>	90,000 hrs, L90 (Ta 35°C)
<b>Fixture Dimensions</b>	See page 2
<b>IP Rating</b>	IP67
<b>Impact Resistance</b>	IK10
<b>Walk Over Rating</b>	Up to 3307 lbs

## ORDERING INFORMATION

Example: F10135.3.5.02.US. Power Supplies / Accessories ordered separately.

		5		US
<b>Model No.</b>	<b>Finish</b>	<b>CCT</b>	<b>Optics</b>	
F10135 - Round	3 - Anodized Matte Black	5 - RGB+W	02 - Medium 30°	US
F10136 - Square	5 - Anodized Aluminum 6 - AISI 316L Stainless Steel 9 - Total Glass <i>(Total Glass only available in trimless)</i>		05 - Diffuse	

Job Name/Date:

Fixture Type Designation:

## FIXTURE DIMENSIONS

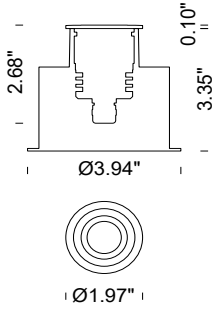

FLEA Recessed Round Trim

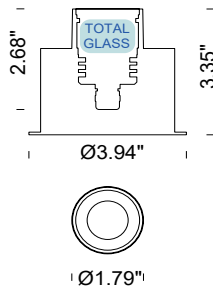

FLEA Recessed Round Trimless (Total Glass)

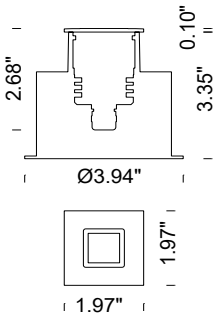

FLEA Recessed Square Trim

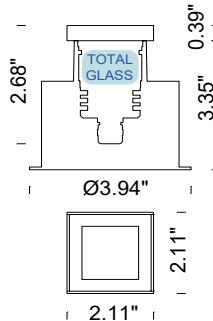

FLEA Recessed Square Trimless (Total Glass)



## SUGGESTED POWER SUPPLIES

24VDC

Part Number	Description	Input/Output	# of Fixtures
<a href="#">PPLT00288-P</a>	DMX / RDM (Field Addressable) / DALI	120-277VAC to 24VDC, 100W, Class 2, DRY	1-10

For other power supply options consult factory.

## ACCESSORIES

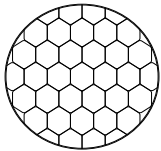

### A1007

Honeycomb Screen

Order together with the product

Job Name/Date:

Fixture Type Designation: