

FLEA

A FLEA? NO, DON'T WORRY. OUR FLEA DOES NOT JUMP HERE AND THERE, IT IS ONE OF OUR LIGHT FIXTURES THAT CAN BE EASILY ADAPTED TO ANY ENVIRONMENT. IT HAS A SLEEK LOOK AND A HIGH EFFICIENCY. WE HAVE DESIGNED IT THIS WAY TO RESPOND TO THE NUMEROUS REQUESTS FOR A MULTIFUNCTIONAL LIGHTING AND FINISHES, SO THAT YOU CAN ALWAYS FIND SOMETHING TO SUIT YOUR SPACE. NO JUMPS.

COMMON FEATURES:

- 6026 ANTICORODAL ALUMINUM HOUSING.
- ANODIZED OXIDATION TREATMENT 30 MICRON (UNI ISO9227:2012 SALINE TEST COMPLIANT).
- EXTRA CLEAR TEMPERED GLASS SCREEN.
- SINGLE-CABLE INPUT, PRE-ASSEMBLED WITH NEOPRENE CABLE (16.40FT FOR SUBMERSION VERSION).
- SILICON GASKET.
- COMPLIANT EN60598-1 AND RELATED ANNEX.

RECESSED INGROUND FEATURES:

- AVAILABLE ALSO WITH MARINE GRADE STAINLESS STEEL 31 6L RING (GALVANIZED TREATMENT ON REQUEST) OR FULL GLASS RING.
- POLYPROPYLENE RECESSING BOX.

RECESSED DOWNLIGHT FEATURES:

- STAINLESS STEEL CLIPS.

UNDERWATER FEATURES:

- MARINE GRADE STAINLESS STEEL 31 6L HOUSING (GALVANIZED TREATMENT ON REQUEST).
- POLYPROPYLENE RECESSING BOX WITH JOINT FOR CORRUGATE PIPE DIAM. 0.791IN WITH IP68 INTERNAL CABLE-BLOCKER.
- SINGLE-CABLE INPUT, PRE-ASSEMBLED WITH 5 MTS OF NEOPRENE CABLE.

designplan® 

79 Trenton Avenue
Frenchtown, NJ 08825

www.designplan.com

Tel: (908) 996-7710
Fax: (908) 996-7042





ONE SIZE FITS ALL

BUILDING A HOUSE OR AN OUTDOOR SPACE REQUIRES PLANNING AHEAD, RIGHT? THAT'S WHY THE FLEA COLLECTION OF RECESSED LIGHTING USES A SINGLE OUTER CASING SIZE, SO YOU CAN FOCUS ON THE ARCHITECTURAL DESIGN AND CHOOSE WHICH FRANCESCO NI LIGHT FIXTURE IS RIGHT FOR YOU IN THE FUTURE.



NO HASSLE REPLACEMENT

HOW WOULD YOU FEEL IF YOUR CAR ASHTRAY BROKE, AND YOU HAD TO REPLACE THE ENTIRE CAR IN ORDER TO GET A NEW ONE? TO AVOID THIS HASSLE, WE HAVE SEPARATED FLEA INTO PARTS. SO, IN CASE SOMETHING GOES WRONG (ALTHOUGH WE'RE WILLING TO BET IT WON'T) YOU JUST NEED TO REPLACE THAT SPECIFIC COMPONENT.



A TRANSPARENT CHOICE

BETWEEN THE LIGHT SOURCE AND YOUR EYES, THERE IS A GLASS SCREEN. IF DESIGNED POORLY, THIS GLASS SCREEN COULD CANCEL OUT THE WORK PUT IN PLACE TO EMIT WELL CALIBRATED LIGHT. FOR THIS REASON, WE WANT THE GLASS TO APPEAR AS TRANSPARENT AS POSSIBLE. IT IS 0.20IN THICK WITH A SMALL AMOUNT OF LEAD TO PRESERVE THE WHITENESS OF YOUR LIGHT.



THE HIDDEN INGENUITY

SOMETIMES, THE COMPLEXITY OF A DEVICE ISN'T SO APPARENT. IN FACT, OUR CONNECTORS, THOUGH EASY TO USE, ARE QUITE COMPLEX DEVICES. THEY CONTAIN ALL CONTROLS NEEDED TO MAKE THE FLEA COLLECTION DEVICES WORK LIKE CLOCKWORK!
YOUR LIGHT FIXTURE WILL RUN SMOOTHLY WHETHER YOU NEED AN ADVANCED DMX CONTROLLER, OR A SINGLE FUNCTION CONTROLLER.

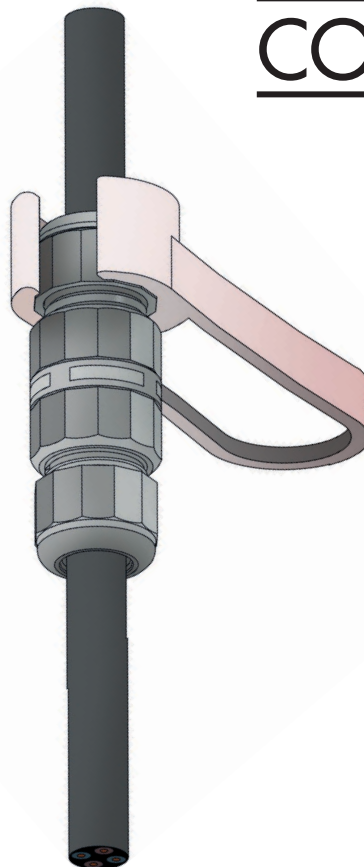

IP68 QUICK CONNECTION

IMAGINE THE INCONVENIENCE IT WOULD BE, TO HAVE TO CONNECT MULTIPLE CABLES IN ORDER TO INSTALL A LIGHT FIXTURE. IMAGINE THE AMOUNT OF TIME LOST IN THIS PROCESS, AND THE RISK THAT ONE OF THE CABLES OR CONNECTORS COULD BE FAULTY. TO AVOID THESE TYPES OF INSTALLATION PROBLEMS, THE ENTIRE FLEA COLLECTION COMES PRE-ASSEMBLED WITH A CABLE AND AN IP68 CONNECTOR TO GUARANTEE MAXIMUM SPEED AND RELIABILITY DURING INSTALLATION. SO, SIT BACK AND RELAX!









TERMINAL 1 AEROPORTO OLBIA - SASSARI - ITALY

FLEA MINI RECESSED



PERFORMANCE DATA

TRUE POWER (W) 2.0
 TRUE LUMENS (3000K) 150 (.01)
 TRUE LUMENS (4000K) 156 (.01)
 L90 LIFETIME (HRS) 90,000 - T_a 35°C

2.0
 150 (.01)
 156 (.01)
 90,000 - T_a 35°C

BUILD DATA

NOMINAL VOLTAGE 24VDC - DIMMABLE
 POWER SUPPLY SEE DATASHEET
 EXTERNAL CABLE SINGLE INPUT
 2-POLES NEOPRENE
 PROTECTION RATING IP67 - IK10
 MAX LOAD 3306.93 LBS (WALK OVER)

24VDC - DIMMABLE
 SEE DATASHEET
 SINGLE INPUT
 2-POLES NEOPRENE
 IP67 - IK10
 3306.93 LBS (WALK OVER)

DIMENSIONS

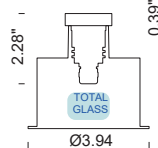
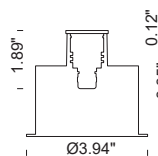
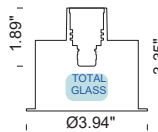
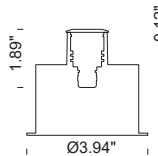

CODE COMPOSITION



- FINISH
 - .3 - ANODIZED MATTE BLACK
 - .5 - ANODIZED ALUMINUM
 - .6 - AISI 316L S.STEEL
 - .9 - TOTAL GLASS
- LED COLOR
 - .2 - 2700°K - CRI > 80
 - .3 - 3000°K - CRI > 80
 - .4 - 4000°K - CRI > 80
- ▲ BEAM
 - .01 - 10° SPOT
 - .02 - 30° MEDIUM
 - .04 - 14° X 20° ELLIPTICAL
 - .05 - DIFFUSED



- FINISH
 - .3 - ANODIZED MATTE BLACK
 - .5 - ANODIZED ALUMINUM
 - .6 - AISI 316L S.STEEL
 - .9 - TOTAL GLASS
- ▲ BEAM
 - .01 - 10° SPOT
 - .02 - 30° MEDIUM
 - .04 - 14° X 20° ELLIPTICAL
 - .05 - DIFFUSED

ACCESSORIES

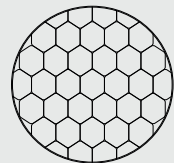

HONEYCOMB SCREEN
 (TO BE ORDERED TOGETHER
 WITH THE PRODUCT)

A1006

FLEA MINI RECESSED

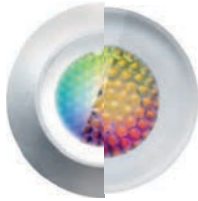

PERFORMANCE DATA

TRUE POWER (W)
TRUE LUMENS (3000K)
TRUE LUMENS (4000K)
L90 LIFETIME (HRS)

5 (ALL COLORS)
R=25, G=52,
B=13, W=84 (6500K)
90,000 - Ta 35°C

5 (ALL COLORS)
R=25, G=52,
B=13, W=84 (6500K)
90,000 - Ta 35°C

BUILD DATA

NOMINAL VOLTAGE
POWER SUPPLY
EXTERNAL CABLE

24VDC
SEE DATASHEET
SINGLE INPUT
8-POLES NEOPRENE
IP67 - IK10
3306.93 LBS (WALK OVER)

24VDC
SEE DATASHEET
SINGLE INPUT
8-POLES NEOPRENE
IP67 - IK10
3306.93 LBS (WALK OVER)

DIMENSIONS

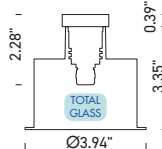
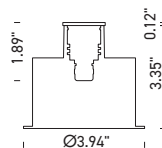
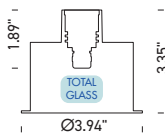
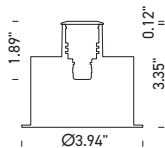

CODE COMPOSITION

10112



● FINISH

.3 - ANODIZED MATTE BLACK
.5 - ANODIZED ALUMINUM
.6 - AISI 316L S.STEEL
.9 - TOTAL GLASS

■ LED COLOR

.5 - RGB+W

▲ BEAM

.02 - 30° MEDIUM
.05 - DIFFUSED

10113



.3 - ANODIZED MATTE BLACK
.5 - ANODIZED ALUMINUM
.6 - AISI 316L S.STEEL
.9 - TOTAL GLASS

.5 - RGB+W

.02 - 30° MEDIUM
.05 - DIFFUSED

ACCESSORIES

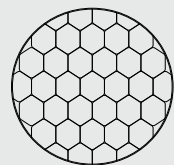

HONEYCOMB SCREEN
(TO BE ORDERED TOGETHER
WITH THE PRODUCT)

A1006

FLEA MINI DOWNLIGHT

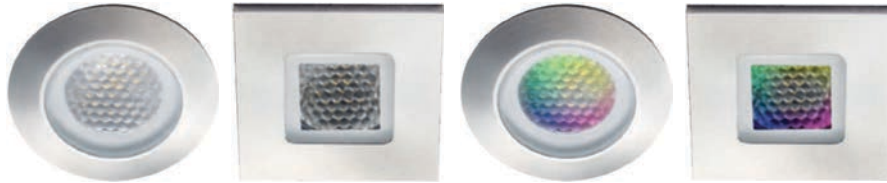

PERFORMANCE DATA

TRUE POWER (W)	2.0	2.0	5 (ALL COLORS)	5 (ALL COLORS)
TRUE LUMENS (3000K)	150 (.01)	150 (.01)	R=25, G=52,	R=25, G=52,
TRUE LUMENS (4000K)	156 (.01)	156 (.01)	B=13, W=84 (6500K)	B=13, W=84 (6500K)
L90 LIFETIME (HRS)	90,000 - T _a 35°C	90,000 - T _a 35°C	90,000 - T _a 35°C	90,000 - T _a 35°C

BUILD DATA

NOMINAL VOLTAGE	24VDC	24VDC	24VDC	24VDC
POWER SUPPLY	SEE DATASHEET	SEE DATASHEET	SEE DATASHEET	SEE DATASHEET
EXTERNAL CABLE	SINGLE INPUT	SINGLE INPUT	SINGLE INPUT	SINGLE INPUT
PROTECTION RATING	2-POLES NEOPRENE IP67 - IK10	2-POLES NEOPRENE IP67 - IK10	8-POLES NEOPRENE IP67 - IK10	8-POLES NEOPRENE IP67 - IK10

DIMENSIONS

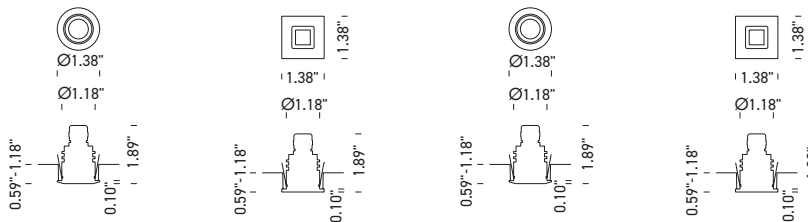

CODE COMPOSITION

	20110	20111	20112	20113
● FINISH	.3 - ANODIZED MATTE BLACK .5 - ANODIZED ALUMINUM .6 - AISI 316L S.STEEL	.3 - ANODIZED MATTE BLACK .5 - ANODIZED ALUMINUM .6 - AISI 316L S.STEEL	.3 - ANODIZED MATTE BLACK .5 - ANODIZED ALUMINUM .6 - AISI 316L S.STEEL	.3 - ANODIZED MATTE BLACK .5 - ANODIZED ALUMINUM .6 - AISI 316L S.STEEL
■ LED COLOR	.2 - 2700°K - CRI > 80 .3 - 3000°K - CRI > 80 .4 - 4000°K - CRI > 80	.2 - 2700°K - CRI > 80 .3 - 3000°K - CRI > 80 .4 - 4000°K - CRI > 80	.5 - RGB+W	.5 - RGB+W
▲ BEAM	.01 - 10° SPOT .02 - 30° MEDIUM .04 - 14° X 20° ELLIPTICAL .05 - DIFFUSED	.01 - 10° SPOT .02 - 30° MEDIUM .04 - 14° X 20° ELLIPTICAL .05 - DIFFUSED	.02 - 30° MEDIUM .05 - DIFFUSED	.02 - 30° MEDIUM .05 - DIFFUSED

ACCESSORIES

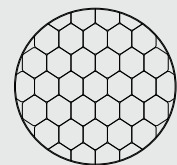

HONEYCOMB SCREEN
(TO BE ORDERED TOGETHER
WITH THE PRODUCT)

A1006

FLEA MINI UNDERWATER



PERFORMANCE DATA

TRUE POWER (W)	2.0	5 (ALL COLORS)	2.0	5 (ALL COLORS)
TRUE LUMENS (3000K)	150 (.01)	R=25, G=52,	150 (.01)	R=25, G=52,
TRUE LUMENS (4000K)	156 (.01)	B=13, W=84 (6500K)	156 (.01)	B=13, W=84 (6500K)
L90 LIFETIME (HRS)	90,000 - T _a 35°C	90,000 - T _a 35°C	90,000 - T _a 35°C	90,000 - T _a 35°C

BUILD DATA

NOMINAL VOLTAGE	24VDC	24VDC	24VDC	24VDC
POWER SUPPLY	SEE DATSHEET	SEE DATSHEET	SEE DATSHEET	SEE DATSHEET
EXTERNAL CABLE	2-POLES NEOPRENE 16.40FT IP68 9.84FT	SINGLE INPUT 8-POLES FEP+RUBBER 16.40FT IP68 9.84FT	SINGLE INPUT 2-POLES NEOPRENE 16.40FT IP68 9.84FT	SINGLE INPUT 8-POLES FEP + RUBBER 16.40FT IP68 9.84FT
PROTECTION RATING				

DIMENSIONS

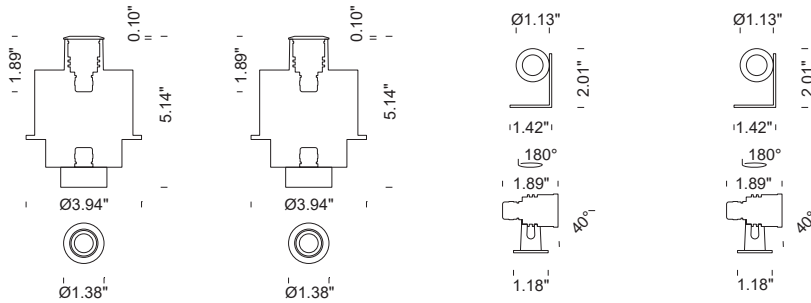

CODE COMPOSITION

	50103	50104	50132	50133
● FINISH	.6 - AISI 316L S.STEEL	.6 - AISI 316L S.STEEL	.6 - AISI 316L S.STEEL	.6 - AISI 316L S.STEEL
■ LED COLOR	.2 - 2700°K - CRI > 80 .3 - 3000°K - CRI > 80 .4 - 4000°K - CRI > 80	.5 - RGB+W	.2 - 2700°K - CRI > 80 .3 - 3000°K - CRI > 80 .4 - 4000°K - CRI > 80	.5 - RGB+W
▲ BEAM	.01 - 10° SPOT .02 - 30° MEDIUM .04 - 14° X 20° ELLIPTICAL .05 - DIFFUSED	.02 - 30° MEDIUM .05 - DIFFUSED	.01 - 10° SPOT .02 - 30° MEDIUM .04 - 14° X 20° ELLIPTICAL .05 - DIFFUSED	.02 - 30° MEDIUM .05 - DIFFUSED

FLEA RECESSED



PERFORMANCE DATA

TRUE POWER (W) 4.0
 TRUE LUMENS (3000K) 411 (.01)
 TRUE LUMENS (4000K) 428 (.01)
 L90 LIFETIME (HRS) 90,000 - T_a 35°C

TRUE POWER (W) 4.0
 TRUE LUMENS (3000K) 411 (.01)
 TRUE LUMENS (4000K) 428 (.01)
 L90 LIFETIME (HRS) 90,000 - T_a 35°C

BUILD DATA

NOMINAL VOLTAGE 24VDC - DIMMABLE
 POWER SUPPLY SEE DATASHEET
 EXTERNAL CABLE SINGLE INPUT
 2-POLES NEOPRENE
 PROTECTION RATING IP67 - IK10
 MAX LOAD 3306.93 LBS (WALK OVER)

NOMINAL VOLTAGE 24VDC - DIMMABLE
 POWER SUPPLY SEE DATASHEET
 EXTERNAL CABLE SINGLE INPUT
 2-POLES NEOPRENE
 PROTECTION RATING IP67 - IK10
 MAX LOAD 3306.93 LBS (WALK OVER)

DIMENSIONS

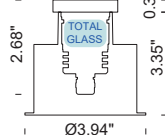
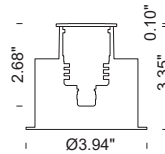
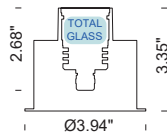
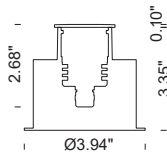

CODE COMPOSITION



- FINISH
 - .3 - ANODIZED MATTE BLACK
 - .5 - ANODIZED ALUMINUM
 - .6 - AISI 316L S.STEEL
 - .9 - TOTAL GLASS
- LED COLOR
 - .2 - 2700°K - CRI > 80
 - .3 - 3000°K - CRI > 80
 - .4 - 4000°K - CRI > 80
- ▲ BEAM
 - .01 - 10° SPOT
 - .02 - 30° MEDIUM
 - .04 - 14° X 20° ELLIPTICAL
 - .05 - DIFFUSED



- FINISH
 - .3 - ANODIZED MATTE BLACK
 - .5 - ANODIZED ALUMINUM
 - .6 - AISI 316L S.STEEL
 - .9 - TOTAL GLASS
- LED COLOR
 - .2 - 2700°K - CRI > 80
 - .3 - 3000°K - CRI > 80
 - .4 - 4000°K - CRI > 80
- ▲ BEAM
 - .01 - 10° SPOT
 - .02 - 30° MEDIUM
 - .04 - 14° X 20° ELLIPTICAL
 - .05 - DIFFUSED

ACCESSORIES

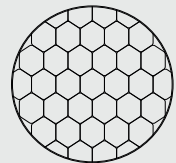

HONEYCOMB SCREEN
 (TO BE ORDERED TOGETHER
 WITH THE PRODUCT)

A1007

FLEA RECESSED

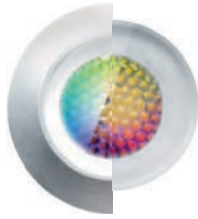

PERFORMANCE DATA

TRUE POWER (W)
TRUE LUMENS (3000K)
TRUE LUMENS (4000K)
L90 LIFETIME (HRS)

8 (ALL COLORS)
R=28, G=70,
B=17, W=96 (6500K)
90,000 - T_a 35°C

8 (ALL COLORS)
R=28, G=70,
B=17, W=96 (6500K)
90,000 - T_a 35°C

BUILD DATA

NOMINAL VOLTAGE
POWER SUPPLY
EXTERNAL CABLE

24VDC
SEE DATASHEET
SINGLE INPUT
8-POLES NEOPRENE
IP67 - IK10
3306.93 LBS (WALK OVER)

24VDC
SEE DATASHEET
SINGLE INPUT
8-POLES NEOPRENE
IP67 - IK10
3306.93 LBS (WALK OVER)

DIMENSIONS

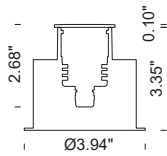

Ø3.94"



Ø1.97"

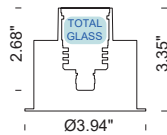

Ø3.94"



Ø1.79"

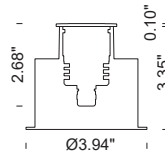

Ø3.94"



1.97"

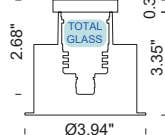

Ø3.94"



2.11"

CODE COMPOSITION

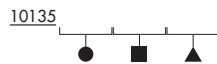

● FINISH

.3 - ANODIZED MATTE BLACK
.5 - ANODIZED ALUMINUM
.6 - AISI 316L S.STEEL
.9 - TOTAL GLASS

■ LED COLOR

.5 - RGB+W

▲ BEAM

.02 - 30° MEDIUM
.05 - DIFFUSED

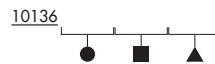

.3 - ANODIZED MATTE BLACK
.5 - ANODIZED ALUMINUM
.6 - AISI 316L S.STEEL
.9 - TOTAL GLASS

.5 - RGB+W

.02 - 30° MEDIUM
.05 - DIFFUSED

ACCESSORIES

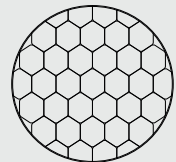

HONEYCOMB SCREEN
(TO BE ORDERED TOGETHER
WITH THE PRODUCT)

A1007

FLEA C



1 x 180°



2 x 120°

PERFORMANCE DATA

TRUE POWER (W) 4.0
 TRUE LUMENS (3000K) 67 (.05)
 TRUE LUMENS (4000K) 70 (.05)
 L90 LIFETIME (HRS) 90,000 - T_a 35°C

TRUE POWER (W) 4.0
 TRUE LUMENS (3000K) 80 (.05)
 TRUE LUMENS (4000K) 83 (.05)
 L90 LIFETIME (HRS) 90,000 - T_a 35°C

BUILD DATA

NOMINAL VOLTAGE 24VDC - DIMMABLE
 POWER SUPPLY SEE DATASHEET
 EXTERNAL CABLE SINGLE INPUT
 2-POLES NEOPRENE
 BEAM 1 x 180°
 PROTECTION RATING IP67 - IK10
 MAXIMUM LOAD 3306.93 LBS (WALK OVER)

NOMINAL VOLTAGE 24VDC - DIMMABLE
 POWER SUPPLY SEE DATASHEET
 EXTERNAL CABLE SINGLE INPUT
 2-POLES NEOPRENE
 BEAM 2 x 120°
 PROTECTION RATING IP67 - IK10
 MAXIMUM LOAD 3306.93 LBS (WALK OVER)

DIMENSIONS

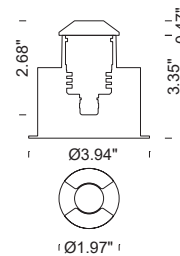
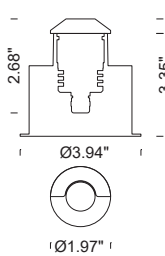

CODE COMPOSITION

10167



● FINISH
 .3 - ANODIZED MATTE BLACK
 .5 - ANODIZED ALUMINUM
 .6 - AISI 316L S.STEEL

■ LED COLOR
 .2 - 2700°K - CRI > 80
 .3 - 3000°K - CRI > 80
 .4 - 4000°K - CRI > 80

▲ BEAM
 .05 - DIFFUSED

10168



● FINISH
 .3 - ANODIZED MATTE BLACK
 .5 - ANODIZED ALUMINUM
 .6 - AISI 316L S.STEEL

■ LED COLOR
 .2 - 2700°K - CRI > 80
 .3 - 3000°K - CRI > 80
 .4 - 4000°K - CRI > 80

▲ BEAM
 .05 - DIFFUSED

FLEA DOWNLIGHT

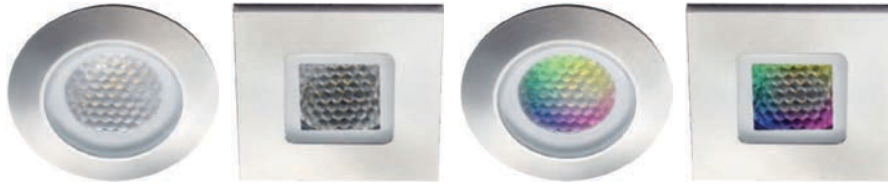

PERFORMANCE DATA

TRUE POWER (W)	4.0	4.0	8 (ALL COLORS)	8 (ALL COLORS)
TRUE LUMENS (3000K)	411 (.01)	411 (.01)	R=28, G=70,	R=28, G=70,
TRUE LUMENS (4000K)	428 (.01)	428 (.01)	B=17, W=96 (6500K)	B=17, W=96 (6500K)
L90 LIFETIME (HRS)	90,000 - T _a 35°C	90,000 - T _a 35°C	90,000 - TA 35°C	90,000 - TA 35°C

BUILD DATA

NOMINAL VOLTAGE	24VDC	24VDC	24VDC	24VDC
POWER SUPPLY	SEE DATASHEET	SEE DATASHEET	SEE DATASHEET	SEE DATASHEET
EXTERNAL CABLE	SINGLE INPUT	SINGLE INPUT	SINGLE INPUT	SINGLE INPUT
PROTECTION RATING	2-POLES NEOPRENE IP67 - IK10	2-POLES NEOPRENE IP67 - IK10	8-POLES NEOPRENE IP67 - IK10	8-POLES NEOPRENE IP67 - IK10

DIMENSIONS

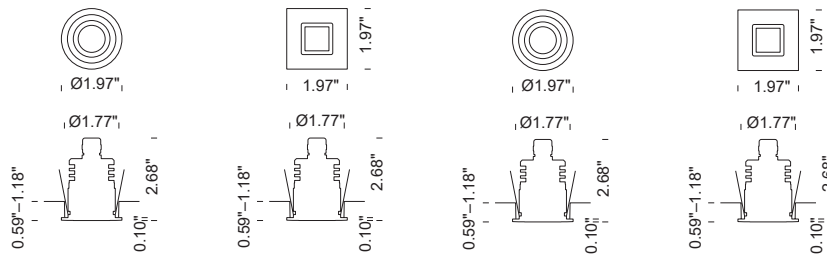

CODE COMPOSITION

	20133	20134	20135	20136
● FINISH	.3 - ANODIZED MATTE BLACK .5 - ANODIZED ALUMINUM .6 - AISI 316L S.STEEL	.3 - ANODIZED MATTE BLACK .5 - ANODIZED ALUMINUM .6 - AISI 316L S.STEEL	.3 - ANODIZED MATTE BLACK .5 - ANODIZED ALUMINUM .6 - AISI 316L S.STEEL	.3 - ANODIZED MATTE BLACK .5 - ANODIZED ALUMINUM .6 - AISI 316L S.STEEL
■ LED COLOR	.2 - 2700°K - CRI > 80 .3 - 3000°K - CRI > 80 .4 - 4000°K - CRI > 80	.2 - 2700°K - CRI > 80 .3 - 3000°K - CRI > 80 .4 - 4000°K - CRI > 80	.5 - RGB+W	.5 - RGB+W
▲ BEAM	.01 - 10° SPOT .02 - 30° MEDIUM .04 - 14° X 20° ELLIPTICAL .05 - DIFFUSED	.01 - 10° SPOT .02 - 30° MEDIUM .04 - 14° X 20° ELLIPTICAL .05 - DIFFUSED	.02 - 30° MEDIUM .05 - DIFFUSED	.02 - 30° MEDIUM .05 - DIFFUSED

ACCESSORIES

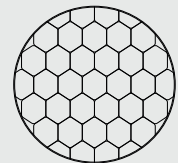

HONEYCOMB SCREEN
(TO BE ORDERED TOGETHER
WITH THE PRODUCT)

A1007

FLEA UNDERWATER



PERFORMANCE DATA

TRUE POWER (W)	4.0	8 (ALL COLORS)	4.0	8 (ALL COLORS)
TRUE LUMENS (3000K)	411 (.01)	R=28, G=70,	411 (.01)	R=28, G=70,
TRUE LUMENS (4000K)	428 (.01)	B=17, W=96 (6500K)	428 (.01)	B=17, W=96 (6500K)
L90 LIFETIME (HRS)	90,000 - T _a 35°C	90,000 - T _a 35°C	90,000 - T _a 35°C	90,000 - T _a 35°C

BUILD DATA

NOMINAL VOLTAGE	24VDC	24VDC	24VDC	24VDC
POWER SUPPLY	SEE DATASHEET	SEE DATASHEET	SEE DATASHEET	SEE DATASHEET
EXTERNAL CABLE	SINGLE INPUT	SINGLE INPUT	SINGLE INPUT	SINGLE INPUT
PROTECTION RATING	2-POLES NEOPRENE 16.40FT IP68 - 9.84FT	8-POLES FEP+RUBBER 16.40FT IP68 - 9.84FT	2-POLES NEOPRENE 16.40FT IP68 - 9.84FT	8-POLES FEP+RUBBER 16.40FT IP68 - 9.84FT

DIMENSIONS

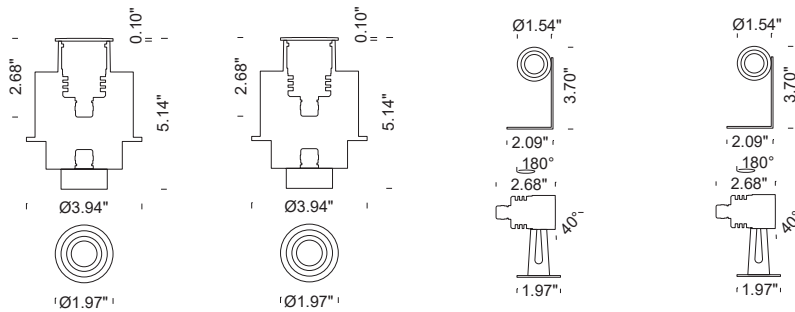

CODE COMPOSITION

	50114	50115	50134	50135
● FINISH	.6 - AISI 316L S.STEEL	.6 - AISI 316L S.STEEL	.6 - AISI 316L S.STEEL	.6 - AISI 316L S.STEEL
■ LED COLOR	.3 - 3000°K - CRI > 80 .4 - 4000°K - CRI > 80	.5 - RGB+W	.3 - 3000°K - CRI > 80 .4 - 4000°K - CRI > 80	.5 - RGB+W
▲ BEAM	.01 - 10° SPOT .02 - 30° MEDIUM .04 - 14° X 20° ELLIPTICAL .05 - DIFFUSED	.02 - 30° MEDIUM .05 - DIFFUSED	.01 - 10° SPOT .02 - 30° MEDIUM .04 - 14° X 20° ELLIPTICAL .05 - DIFFUSED	.02 - 30° MEDIUM .05 - DIFFUSED

DARK THEME MODE: ON

OUR MATERIALS ARE BOTH REFINED AND FUNCTIONAL. THEY PROVIDE EXCELLENT LIGHTING, ARE MECHANICALLY PRECISE, AND NOTICEABLY STYLISH. SOME SPACES REQUIRE A DIFFERENT DECOR; FOR THIS REASON, WE HAVE COMBINED OUR TRADITIONAL FINISHES WITH AN ELEGANT MATTE BLACK VARIANT IN TO FRAME THE FANTASTIC FLEA PRODUCTS THAT YOU'RE ALREADY USED TO.

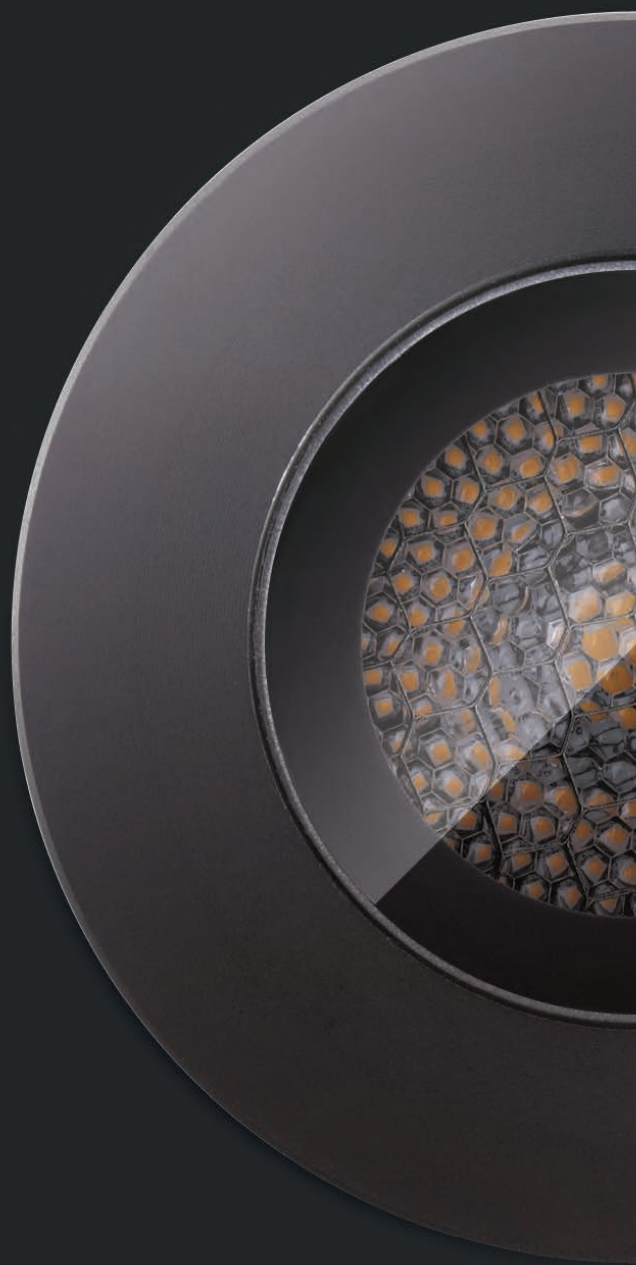
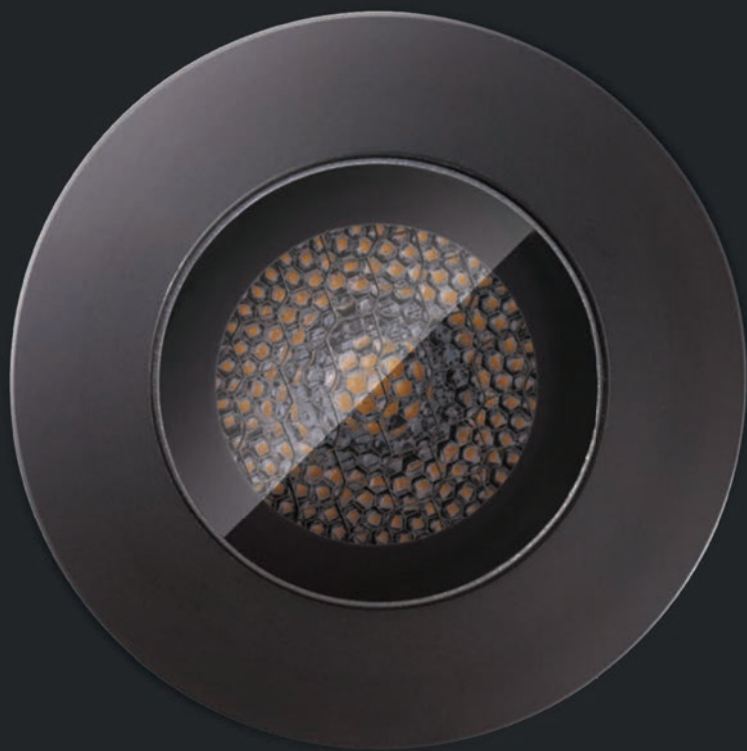

IN ORDER TO AVOID DAZZLING, SOMETIMES YOU WOULD FEEL THE NEED OF FILTERING THE LIGHT. IF THIS IS YOUR CASE, FLEA MAKES YOU HAPPY WITH A RANGE OF MESH ACCESSORIES SOLD SEPARATELY FOR THE WHOLE COLLECTION. YOU CHOOSE!

FLEA MAXI RECESSED



PERFORMANCE DATA

TRUE POWER (W)	8.5
TRUE LUMENS (3000K)	464 (.01)
TRUE LUMENS (4000K)	484 (.01)
L90 LIFETIME (HRS)	90,000 - T _a 35°C

TRUE POWER (W)	8.5
TRUE LUMENS (3000K)	464 (.01)
TRUE LUMENS (4000K)	484 (.01)
L90 LIFETIME (HRS)	90,000 - T _a 35°C

BUILD DATA

NOMINAL VOLTAGE	24VDC - DIMMABLE
POWER SUPPLY	SEE DATASHEET
EXTERNAL CABLE	SINGLE INPUT
PROTECTION RATING	2-POLES NEOPRENE
MAX LOAD	IP67 - IK10 3306.93 LBS (WALK OVER)

NOMINAL VOLTAGE	24VDC - DIMMABLE
POWER SUPPLY	SEE DATASHEET
EXTERNAL CABLE	SINGLE INPUT
PROTECTION RATING	2-POLES NEOPRENE
MAX LOAD	IP67 - IK10 3306.93 LBS (WALK OVER)

DIMENSIONS

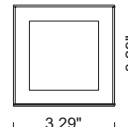
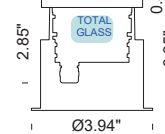
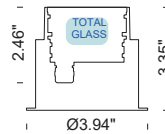
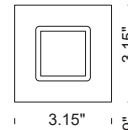
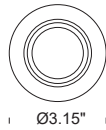
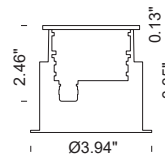
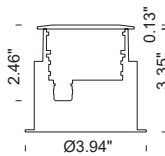

CODE COMPOSITION



● FINISH	.3 - ANODIZED MATTE BLACK .5 - ANODIZED ALUMINUM .6 - AISI 316L S.STEEL .9 - TOTAL GLASS
----------	---

■ LED COLOR	.2 - 2700°K - CRI > 80 .3 - 3000°K - CRI > 80 .4 - 4000°K - CRI > 80
-------------	--

▲ BEAM	.01 - 10° SPOT .05 - DIFFUSED .36 - 25° MEDIUM .32 - 45° WIDE .38 - 10° x 40°
--------	---



● FINISH	.3 - ANODIZED MATTE BLACK .5 - ANODIZED ALUMINUM .6 - AISI 316L S.STEEL .9 - TOTAL GLASS
----------	---

■ LED COLOR	.2 - 2700°K - CRI > 80 .3 - 3000°K - CRI > 80 .4 - 4000°K - CRI > 80
-------------	--

▲ BEAM	.01 - 10° SPOT .05 - DIFFUSED .36 - 25° MEDIUM .32 - 45° WIDE .38 - 10° x 40°
--------	---

ACCESSORIES

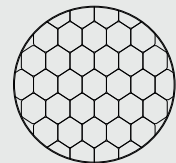

HONEYCOMB SCREEN
(TO BE ORDERED TOGETHER
WITH THE PRODUCT)

A1008

FLEA MAXI RECESSED



CORE

PERFORMANCE DATA

TRUE POWER (W)
TRUE LUMENS (3000K)
TRUE LUMENS (4000K)
L90 LIFETIME (HRS)

12 (ALL COLORS)
R=33, G=84,
B=20, W=116 (6500K)
90,000 - T_a 35°C

BUILD DATA

NOMINAL VOLTAGE
POWER SUPPLY
EXTERNAL CABLE

24VDC - 4xPWM-CV
SEE DATASHEET
SINGLE INPUT
6-POLES FEP + RUBBER
IP67 - IK10
3306.93 LBS (WALK OVER)

DIMENSIONS

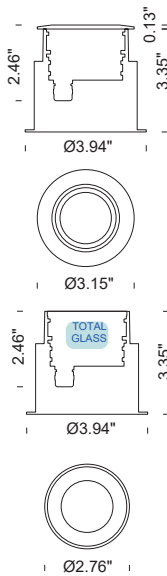

CORE

12 (ALL COLORS)
R=33, G=84,
B=20, W=116 (6500K)
90,000 - T_a 35°C

24VDC - 4xPWM-CV
SEE DATASHEET
SINGLE INPUT
6-POLES FEP + RUBBER
IP67 - IK10
3306.93 LBS (WALK OVER)

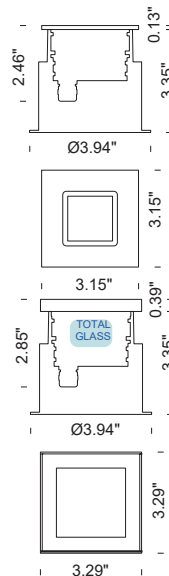

CODE COMPOSITION

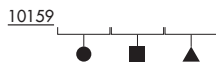

● FINISH

.3 - ANODIZED MATTE BLACK
.5 - ANODIZED ALUMINUM
.6 - AISI 316L S.STEEL
.9 - TOTAL GLASS

■ LED COLOR

.5 - RGB+W

▲ BEAM

.01 - 10° SPOT
.05 - DIFFUSED
.36 - 25° MEDIUM
.32 - 45° WIDE
.38 - 10° x 40°

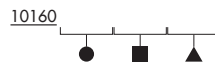

.3 - ANODIZED MATTE BLACK
.5 - ANODIZED ALUMINUM
.6 - AISI 316L S.STEEL
.9 - TOTAL GLASS

.5 - RGB+W

.01 - 10° SPOT
.05 - DIFFUSED
.36 - 25° MEDIUM
.32 - 45° WIDE
.38 - 10° x 40°

ACCESSORIES

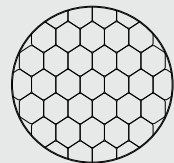

HONEYCOMB SCREEN
(TO BE ORDERED TOGETHER
WITH THE PRODUCT)

A1008

FLEA MAXI C



1 x 180°

PERFORMANCE DATA

TRUE POWER (W) 6.5
 TRUE LUMENS (3000K) 151 (.05)
 TRUE LUMENS (4000K) 157 (.05)
 L90 LIFETIME (HRS) 90,000 - T_a 35°C

BUILD DATA

NOMINAL VOLTAGE 24VDC - DIMMABLE
 POWER SUPPLY SEE DATASHEET
 EXTERNAL CABLE SINGLE INPUT
 2-POLES NEOPRENE
 BEAM 1 x 180°
 PROTECTION RATING IP67 - IK10
 MAXIMUM LOAD 3306.93 LBS (WALK OVER)

DIMENSIONS

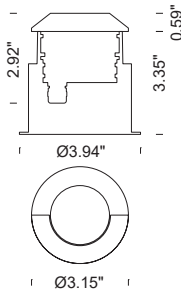

2 x 120°

TRUE POWER (W) 6.5
 TRUE LUMENS (3000K) 179 (.05)
 TRUE LUMENS (4000K) 186 (.05)
 L90 LIFETIME (HRS) 90,000 - T_a 35°C

NOMINAL VOLTAGE 24VDC - DIMMABLE
 POWER SUPPLY SEE DATASHEET
 EXTERNAL CABLE SINGLE INPUT
 2-POLES NEOPRENE
 BEAM 2 x 120°
 PROTECTION RATING IP67 - IK10
 MAXIMUM LOAD 3306.93 LBS (WALK OVER)

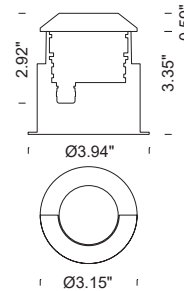

CODE COMPOSITION

10179



● FINISH
 .3 - ANODIZED MATTE BLACK
 .5 - ANODIZED ALUMINUM
 .6 - AISI 316L S.STEEL

■ LED COLOR
 .2 - 2700°K - CRI > 80
 .3 - 3000°K - CRI > 80
 .4 - 4000°K - CRI > 80

▲ BEAM
 .05 - DIFFUSED

10180



● FINISH
 .3 - ANODIZED MATTE BLACK
 .5 - ANODIZED ALUMINUM
 .6 - AISI 316L S.STEEL

■ LED COLOR
 .2 - 2700°K - CRI > 80
 .3 - 3000°K - CRI > 80
 .4 - 4000°K - CRI > 80

▲ BEAM
 .05 - DIFFUSED

FLEA MAXI DOWNLIGHT



CORE

CORE

PERFORMANCE DATA

TRUE POWER (W)	8.5	8.5	12 (ALL COLORS)	12 (ALL COLORS)
TRUE LUMENS (3000K)	464 (.01)	464 (.01)	R=33, G=84,	R=33, G=84,
TRUE LUMENS (4000K)	484 (.01)	484 (.01)	B=20, W=116 (6500K)	B=20, W=116 (6500K)
L90 LIFETIME (HRS)	90,000 (Ta 35°C)	90,000 (Ta 35°C)	90,000 - Ta 35°C	90,000 - Ta 35°C

BUILD DATA

NOMINAL VOLTAGE	24VDC - DIMMABLE	24VDC - DIMMABLE	24VDC - 4xPWM-CV	24VDC - 4xPWM-CV
POWER SUPPLY	SEE DATASHEET	SEE DATASHEET	SEE DATASHEET	SEE DATASHEET
EXTERNAL CABLE	SINGLE INPUT	SINGLE INPUT	SINGLE INPUT	SINGLE INPUT
PROTECTION RATING	2-POLES NEOPRENE IP67 - IK10	2-POLES NEOPRENE IP67 - IK10	6-POLES FEP + RUBBER IP67 - IK10	6-POLES FEP + RUBBER IP67 - IK10

DIMENSIONS

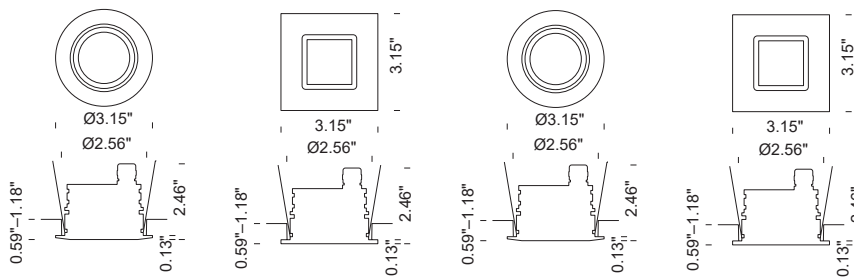

CODE COMPOSITION

	20157	20158	20159	20160
● FINISH	.3 - ANODIZED MATTE BLACK .5 - ANODIZED ALUMINUM .6 - AISI 316L S.STEEL	.3 - ANODIZED MATTE BLACK .5 - ANODIZED ALUMINUM .6 - AISI 316L S.STEEL	.3 - ANODIZED MATTE BLACK .5 - ANODIZED ALUMINUM .6 - AISI 316L S.STEEL	.3 - ANODIZED MATTE BLACK .5 - ANODIZED ALUMINUM .6 - AISI 316L S.STEEL
■ LED COLOR	.2 - 2700°K - CRI > 80 .3 - 3000°K - CRI > 80 .4 - 4000°K - CRI > 80	.2 - 2700°K - CRI > 80 .3 - 3000°K - CRI > 80 .4 - 4000°K - CRI > 80	.5 - RGB+W	.5 - RGB+W
▲ BEAM	.01 - 10° SPOT .05 - DIFFUSED .36 - 25° MEDIUM .32 - 45° WIDE .38 - 10° x 40°	.01 - 10° SPOT .05 - DIFFUSED .36 - 25° MEDIUM .32 - 45° WIDE .38 - 10° x 40°	.01 - 10° SPOT .05 - DIFFUSED .36 - 25° MEDIUM .32 - 45° WIDE .38 - 10° x 40°	.01 - 10° SPOT .05 - DIFFUSED .36 - 25° MEDIUM .32 - 45° WIDE .38 - 10° x 40°

ACCESSORIES

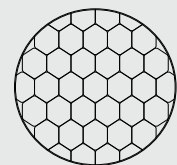

HONEYCOMB SCREEN
(TO BE ORDERED TOGETHER
WITH THE PRODUCT)

A1008

FLEA MAXI UNDERWATER



PERFORMANCE DATA

TRUE POWER (W) 8.5
 TRUE LUMENS (3000K) 464 (.01)
 TRUE LUMENS (4000K) 484 (.01)
 L90 LIFETIME (HRS) 90,000 - T_a 35°C

8.5
 464 (.01)
 484 (.01)
 90,000 - T_a 35°C

BUILD DATA

NOMINAL VOLTAGE 24VDC - DIMMABLE
 POWER SUPPLY SEE DATASHEET
 EXTERNAL CABLE SINGLE INPUT
 PROTECTION RATING 2-POLES NEOPRENE 16.40FT
 IP68 - 9.84FT

III
 24VDC - DIMMABLE
 SEE DATASHEET
 SINGLE INPUT
 2-POLES NEOPRENE 16.40FT
 IP68 - 9.84FT

DIMENSIONS

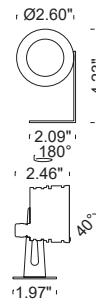
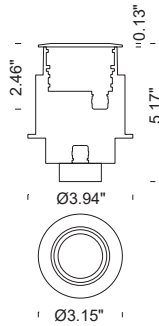

CODE COMPOSITION



● FINISH .6 - AISI 316L S.STEEL
 ■ LED COLOR .3 - 3000°K - CRI > 80
 .4 - 4000°K - CRI > 80
 ▲ BEAM .01 - 10° SPOT
 .05 - DIFFUSED
 .36 - 25° MEDIUM
 .32 - 45° WIDE
 .38 - 10° x 40°



.6 - AISI 316L S.STEEL
 .3 - 3000°K - CRI > 80
 .4 - 4000°K - CRI > 80
 .01 - 10° SPOT
 .05 - DIFFUSED
 .36 - 25° MEDIUM
 .32 - 45° WIDE
 .38 - 10° x 40°

FLEA MAXI UNDERWATER



CORE



PRO (ON-BOARD DMX)



CORE



PRO (ON-BOARD DMX)

PERFORMANCE DATA

TRUE POWER (W)
TRUE LUMENS (3000K)
TRUE LUMENS (4000K)
L90 LIFETIME (HRS)

12 (ALL COLORS)
R=33, G=84,
B=20, W=116 (6500K)
90,000 - T_a 35°C

12 (ALL COLORS)
R=33, G=84,
B=20, W=116 (6500K)
90,000 - T_a 35°C

12 (ALL COLORS)
R=33, G=84,
B=20, W=116 (6500K)
90,000 - T_a 35°C

12 (ALL COLORS)
R=33, G=84,
B=20, W=116 (6500K)
90,000 - T_a 35°C

BUILD DATA

NOMINAL VOLTAGE
POWER SUPPLY
EXTERNAL CABLE

24VDC - 4xPWM-CV
SEE DATASHEET
SINGLE INPUT
6-POLES FEP + RUBBER
16.40FT IP68-9.84FT

24VDC - DMX (RDM)
SEE DATASHEET
SINGLE INPUT
5-POLES FEP + RUBBER
16.40FT IP68-9.84FT

24VDC - 4xPWM-CV
SEE DATASHEET
SINGLE INPUT
6-POLES FEP + RUBBER
16.40FT IP68-9.84FT

24VDC - DMX (RDM)
SEE DATASHEET
SINGLE INPUT
5-POLES FEP + RUBBER 16.40FT
IP68 - 9.84FT

DIMENSIONS

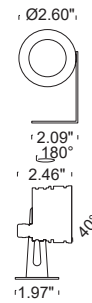
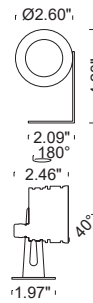
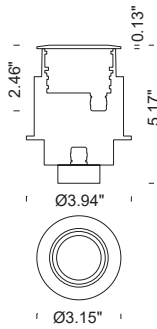
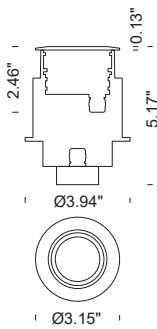

CODE COMPOSITION

50128



.6 - AISI 316L S.STEEL

.5 - RGB+W

.01 - 10° SPOT
.05 - DIFFUSED
.36 - 25° MEDIUM
.32 - 45° WIDE
.38 - 10° x 40°

50129



.6 - AISI 316L S.STEEL

.5 - RGB+W

.01 - 10° SPOT
.05 - DIFFUSED
.36 - 25° MEDIUM
.32 - 45° WIDE
.38 - 10° x 40°

50143



.6 - AISI 316L S.STEEL

.5 - RGB+W

.01 - 10° SPOT
.05 - DIFFUSED
.36 - 25° MEDIUM
.32 - 45° WIDE
.38 - 10° x 40°

50144



.6 - AISI 316L S.STEEL

.5 - RGB+W

.01 - 10° SPOT
.05 - DIFFUSED
.36 - 25° MEDIUM
.32 - 45° WIDE
.38 - 10° x 40°

● FINISH

■ LED COLOR

▲ BEAM



