



**INSTRUCTIONS PERTAINING TO RISK OF FIRE OR INJURY TO PERSONS. READ ALL INSTRUCTIONS. IMPORTANT SAFETY INSTRUCTIONS. SAVE THESE INSTRUCTIONS.**

**DANGER - RISK OF SHOCK - DISCONNECT POWER BEFORE INSTALLATION! Please read all instructions before installation.**

- Keep these instructions for future reference.
- Must be installed by a qualified electrician in accordance with national and local standards. Designplan is not responsible for fixtures installed without regard to these standards.
- Unauthorized alterations or tampering of product voids warranty.
- The main power connection must be in accordance with local electrical codes.
- Suitable for OUTDOOR applications.



**IP65 IK09**

## Electrical Connections:

- LED lights must be **connected in parallel** respecting polarities.
- **CHOOSE POWER SUPPLY ACCORDINGLY.** Please consider the voltage through which fixtures are fed as well as the max power consumption.
- **Connect power only if all the fixtures are connected.**
- The power supplies **MUST** be installed in aerated rooms, far from heat sources. Overworking or lack of air circulation will not permit natural dissipation.
- Use only Class 2 type electronic power supply.
- Never use switches on secondary circuit.

**ATTENTION:** **For In-Grade** - It is the contractor's responsibility to seal the conduit with "Great Stuff" aerosol seal that prevents water and moisture penetration for ultimate protection. Contractor **MUST** use gel-filled wire nuts.

## Maintenance

Scheduled maintenance must be carried out once a year on all lighting devices, regardless of appliance class and type of use. It must include the following operations:

- Periodically clean fixtures to remove dirt from gratings and screw heads.
- Check tightness of screws on various parts of the device.
- Check that all cable glands and cables are intact and tight. Check that the glass or plastic lens is intact, and replace it if broken or damaged.
- The internal components such as the ballast, driver, washers and screws must not show clear signs of oxidation or rust. Clear traces of rust and oxidation will indicate the presence of water inside the device.
- In the case of damage, the components must be replaced by original components or spare parts.

# BAJA PR-160 R, PR-300R

14W, 28W, REMOTE 500mA

designplan®

installation instructions

## SUPPORT PREPARATION :

### BAJA 160

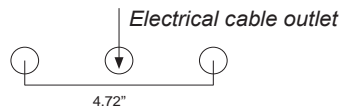

Drilling the installation surface:

For Baja 160 model: drill two holes in the ground with a center distance of 4.72" for a plug for M6 screws (length 0.630").

### BAJA 300

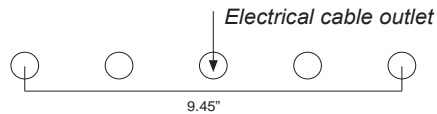

Drilling the installation surface:

For Baja 300 model: drill two holes in the ground with a center distance of 9.45" for a plug for M6 screws (length 0.630").

Note: The required M6 screws are provided.

## FIXTURE INSTALLATION

### FIXTURE INSTALLATION



Prepare the hole for the electrical cable outlet near the installation location of the fixture

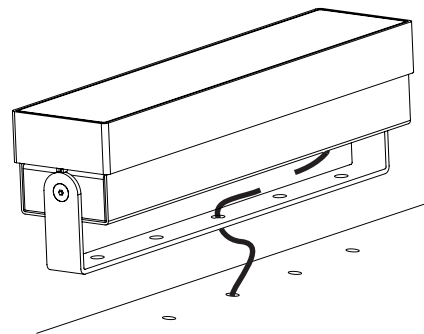

Pass the electrical cable through the designated central hole in the anchoring bracket

## FIXTURE INSTALLATION

Align the fixture with the pre-drilled holes created in the preparation phase

Fix the fixture in place using the provided M6 screws

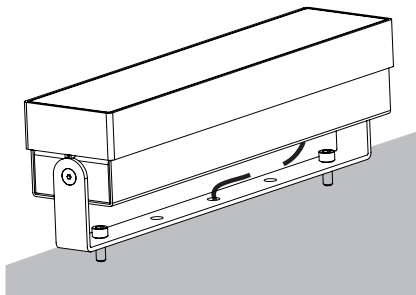

## ELECTRICAL CONNECTION

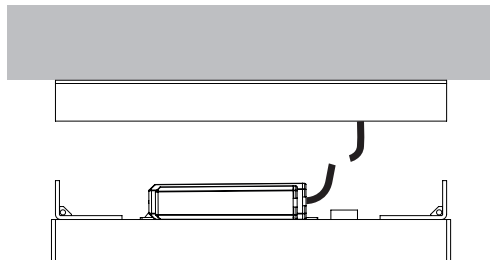

Feed the electrical cable through the central hole in the mounting bracket

Connect the electrical wires using the waterproof wirenut connector.

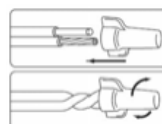

Use gel-filled waterproof wire-nuts for wire connections.

# BAJA PR-160 R, PR-300R

14W, 28W, REMOTE 500mA

designplan®

installation instructions

## CABLE WIRING

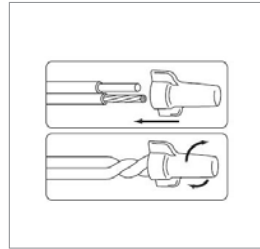
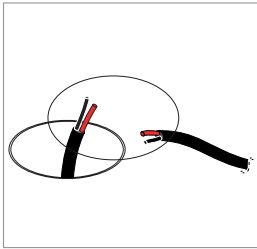

*Important wiring note:*

*Version with integrated driver: connect the blue and brown wires directly to the 120 VAC mains supply.*

*Version with remote driver: connect the red (+) and black (-) wires to the remote driver at low voltage.*

- Use gel-filled waterproof wire-nuts for wire connections.
- It is the contractor's responsibility to install Remote Driver in a suitable electrical enclosure.



## PROJECTOR ADJUSTMENT AND POSITIONING

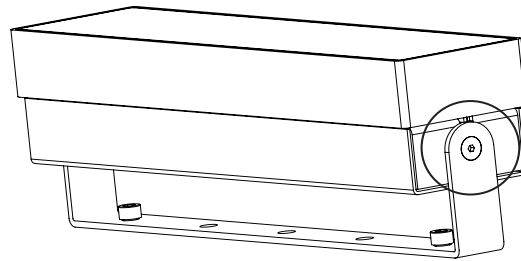
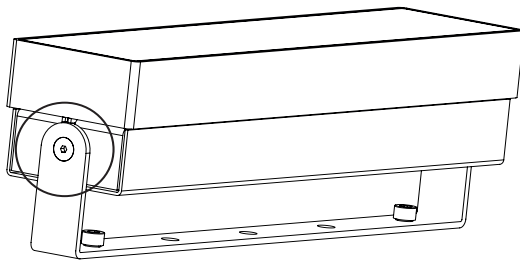

*Loosen the two lateral screws on the fixture*

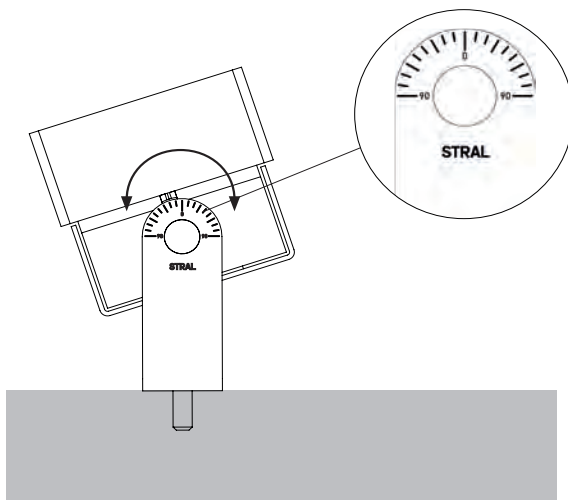

*Adjust the tilt angle as desired using the graduated adjustment ring*

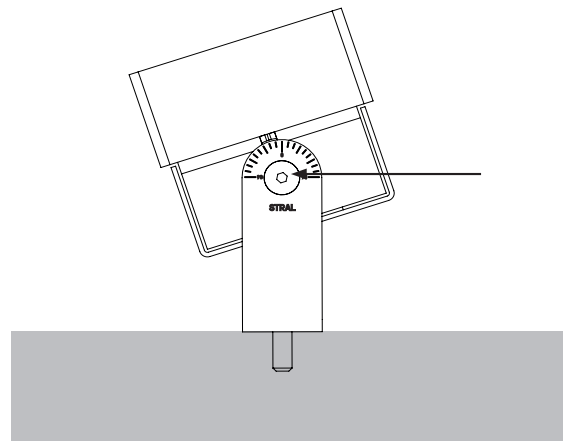

*Once the desired tilt angle is set, tighten the two lateral screws to lock the projector in position*

