

VLAK is a series of recessed wall or in-grade uplight made of stainless steel, including the in-ground embedded part, that comes in round or square version in 2 sizes. VLAK R-50 is the Ø2.0" round 5W version offering 3 color temperatures, and 3 standard Hard Coat Treatment finishes.

TECHNICAL DATA

Wattage	5W
Power Supply	Remote 500mA, not included. See page 2
Construction	Body/Frame: AISI 316L Stainless Steel Lens: Plexiglass
CCT	2700K, 3000K, 4000K
CRI	80
Delivered Lumens	445 lm (3000K)
Efficacy	89 lm/W (3000K)
Optics	Wide
Lumen Maintenance	L80/B10 @100.000h Ta=25°C
Hard Coat Finishes	Inox Natural, Inox Graphite, Inox Bronze
Fixture Dimensions	Ø1.97" x 2.76"
IP Rating	IP66, IP67
Impact Resistance	IK09
Warranty	2 Years Extendable to 5 Years

Hard Coating Treatment is the surface treatment of all the products by Stral Lighting. It is not a skin of color, but instead is a process that allows for the color to be absorbed all the way through. If a product is scratched, the color beneath is the same as the color on the surface. It guarantees a high superficial resistance to corrosion and atmospheric agents, as well as making the products anti-fingerprint and anti-stain. Available in three finishes Inox Natural, Inox Graphite and Inox Bronze.

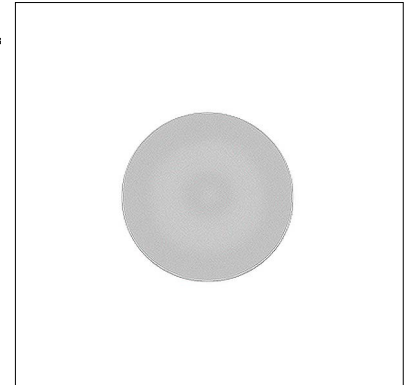

Fixture Dimensions

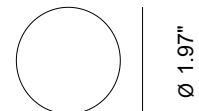
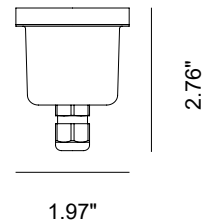

ORDERING INFORMATION

Example: SPT3011024B.US. Power Supplies / Accessories ordered separately.

SPT30110		4		.US
Model No.	CCT	Optics	Finishes	
SPT30110	2 - 2700K 3 - 3000K 4 - 4000K	4 - Wide	N - Inox Natural G - Inox Graphite B - Inox Bronze	.US

Job Name/Date:

Fixture Type Designation:

SUGGESTED POWER SUPPLIES

500mA

Part Number	Description	Input/Output	# of Fixtures
PPLT00469	Phase Dim (120V only)	120VAC to 500mA, 14W, Class 2	1-2
PPLT00262	Leading / Trailing Edge Dimming to 10% (120V only)	120-277VAC to 500mA, 32W, Class 2	2-3
PPLT00467-P	0-10V Dimming to 1.0%	120-277VAC to 500mA, 50W, Class 2, DAMP	1-4
PPLT00561-P500	0-10V Dimming to 0.1%	120-277VAC to 500mA, 100W, Class 2	1-4

Suggested Lutron Compatible

Part Number	Option	Lutron SKU	Dim Range	Description	Input/Output	# of Fixtures
PPLT00259	L3DAE / L3DA3W	L3DA	100%-1%	Hi-Lume™ 1% EcoSystem™ or 1% 3-Wire LED Driver	120-277VAC to 500mA, 10W, Class 2	1-1
PPLT00195	L3DAE / L3DA3W	L3DA	100%-1%	Hi-Lume™ 1% EcoSystem™ or 1% 3-Wire LED Driver	120-277VAC to 500mA, 19W, Class 2	2-3
PPLT00676	PEQ0E	PEQ0	100%-0.1%	Hi-Lume Premier 0.1% EcoSystem™ LED Driver	120-277VAC to 500mA, 20W, Class 2	1-3
PPLT00180	L3DAE / L3DA3W	L3DA	100%-1%	Hi-Lume™ 1% EcoSystem™ or 1% 3-Wire LED Driver	120-277VAC to 500mA, 27W, Class 2	3-4

For other power supply options consult factory.

ACCESSORIES - Installation

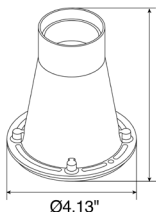
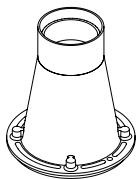

PT51800_
Outer Casing
Ø4.13" base x 4.72" h
Add one of the finish codes below:
N - Inox Natural
G - Inox Graphite
B - Inox Bronze

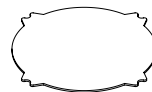

PT40004
Bottom Cap
Ø4.72"

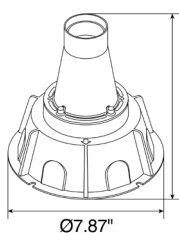
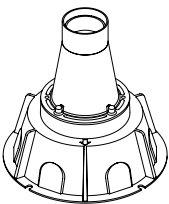

PT51801_
Outer Casing
Ø7.87" base x 7.68" h
Add one of the finish codes below:
N - Inox Natural
G - Inox Graphite
B - Inox Bronze

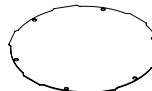

PT40003
Bottom Cap
Ø7.68"

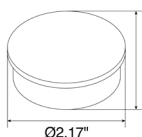

PT40006
Mortar Cap
Ø1.97"

Job Name/Date:

Fixture Type Designation:

PHOTOMETRIC DATA

NOTE: All photometry is 3000K

Maximum Candela = 61.6

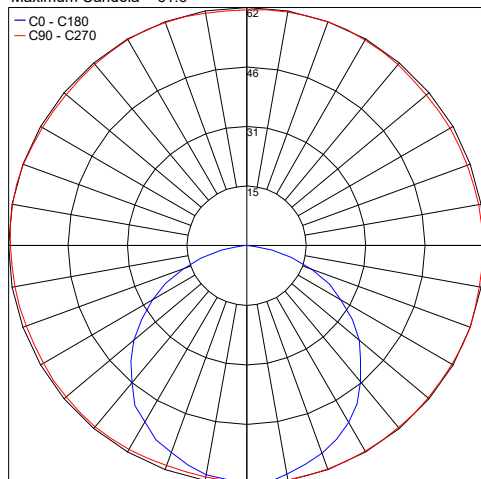

PHOTOMETRIC FILENAME : VLAK R-50 3000K - PT3011034.IES

Job Name/Date:

Fixture Type Designation: