

VLAK is a series of recessed wall or in-grade upright made of stainless steel, including the in-ground embedded part, that comes in round or square version in 2 sizes. VLAK R-70 is the Ø2.8" round 7W version offering 3 color temperatures.

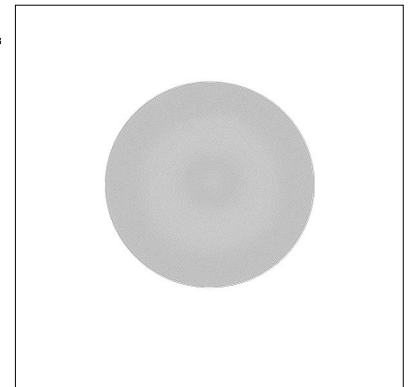

## TECHNICAL DATA

<b>Wattage</b>	7W
<b>Power Supply</b>	Remote 500mA, not included. See page 2
<b>Construction</b>	Body/Frame: AISI 316L Stainless Steel Lens: Plexiglass
<b>CCT</b>	2700K, 3000K, 4000K
<b>CRI</b>	80
<b>Delivered Lumens</b>	607 lm (3000K)
<b>Efficacy</b>	86.7 lm/W (3000K)
<b>Optics</b>	Wide
<b>Lumen Maintenance</b>	L80/B10 @100.000h Ta=25°C
<b>Fixture Dimensions</b>	Ø2.76" x 2.76"
<b>IP Rating</b>	IP66, IP67
<b>Impact Resistance</b>	IK09
<b>Warranty</b>	2 Years Extendable to 5 Years

Fixture Dimensions

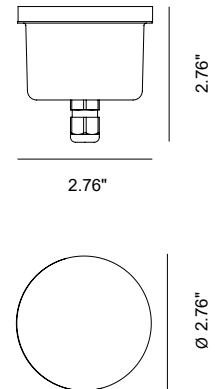

## ORDERING INFORMATION

Example: SPT3012024.US. Power Supplies / Accessories ordered separately.

SPT30120		4	.US
<b>Model No.</b>	<b>CCT</b>	<b>Optics</b>	
SPT30120	2 - 2700K 3 - 3000K 4 - 4000K	4 - Wide	.US

Job Name/Date:

Fixture Type Designation:

## SUGGESTED POWER SUPPLIES

500mA

Part Number	Description	Input/Output	# of Fixtures
<a href="#">PPLT00469</a>	Phase Dim (120V only)	120VAC to 500mA, 14W, Class 2	1-2
<a href="#">PPLT00262</a>	Leading / Trailing Edge Dimming to 10% (120V only)	120-277VAC to 500mA, 32W, Class 2	2-3
<a href="#">PPLT00467-P</a>	0-10V Dimming to 1.0%	120-277VAC to 500mA, 50W, Class 2, DAMP	1-4
<a href="#">PPLT00561-P500</a>	0-10V Dimming to 0.1%	120-277VAC to 500mA, 100W, Class 2	1-4

## Suggested Lutron Compatible

Part Number	Option	Lutron SKU	Dim Range	Description	Input/Output	# of Fixtures
<a href="#">PPLT00259</a>	L3DAE / L3DA3W	L3DA	100%-1%	Hi-Lume™ 1% EcoSystem™ or 1% 3-Wire LED Driver	120-277VAC to 500mA, 10W, Class 2	1-1
<a href="#">PPLT00195</a>	L3DAE / L3DA3W	L3DA	100%-1%	Hi-Lume™ 1% EcoSystem™ or 1% 3-Wire LED Driver	120-277VAC to 500mA, 19W, Class 2	2-3
<a href="#">PPLT00676</a>	PEQ0E	PEQ0	100%-0.1%	Hi-Lume Premier 0.1% EcoSystem™ LED Driver	120-277VAC to 500mA, 20W, Class 2	1-3
<a href="#">PPLT00180</a>	L3DAE / L3DA3W	L3DA	100%-1%	Hi-Lume™ 1% EcoSystem™ or 1% 3-Wire LED Driver	120-277VAC to 500mA, 27W, Class 2	3-4

For other power supply options consult factory.

## ACCESSORIES - Installation

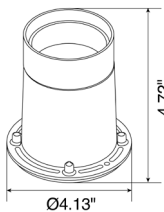
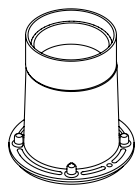

**PT51900\_**  
Outer Casing  
Ø4.13" base x 4.72" h  
Add one of the finish codes below:  
**N** - Inox Natural  
**G** - Inox Graphite  
**B** - Inox Bronze

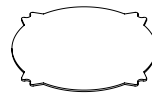

**PT40004**  
Bottom Cap  
Ø4.72"

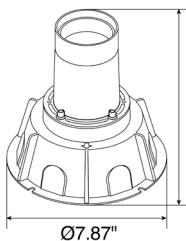
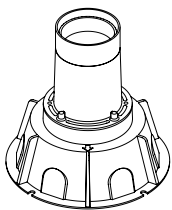

**PT51901\_**  
Outer Casing  
Ø7.87" base x 7.68" h  
Add one of the finish codes below:  
**N** - Inox Natural  
**G** - Inox Graphite  
**B** - Inox Bronze

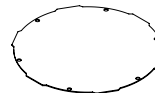

**PT40003**  
Bottom Cap  
Ø7.68"

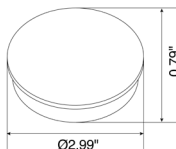
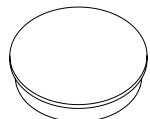

**PT40007**  
Mortar Cap  
Ø3.15"

**Hard Coating Treatment** is the surface treatment of all the products by Stral Lighting. It is not a skin of color, but instead is a process that allows for the color to be absorbed all the way through. If a product is scratched, the color beneath is the same as the color on the surface. It guarantees a high superficial resistance to corrosion and atmospheric agents, as well as making the products anti-fingerprint and anti-stain. Available in three finishes Inox Natural, Inox Graphite and Inox Bronze.

Job Name/Date:

Fixture Type Designation:

## PHOTOMETRIC DATA

NOTE: All photometry is 3000K

Maximum Candela = 84.1

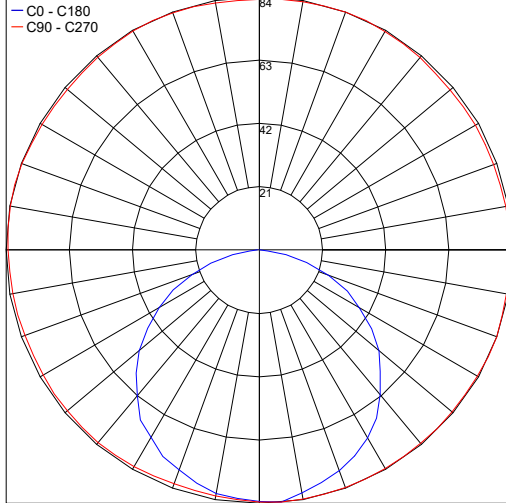

PHOTOMETRIC FILENAME : VLAK R-70 3000K - PT3012034.IES

Job Name/Date:

Fixture Type Designation: