

# DRIVE LINE (L704X)

Drive Line L704X is a customized linear (curved on request) IP68-rated LED luminaire, made in AISI 316L stainless steel, for flush installation on floors in indoor or outdoor areas. It is driveover rated, and available in custom length, max 9.5 feet, and custom curvatures on request to follow every project. It is available in static or tunable white, RGB and RGBW and diffused optics. **Not cuttable in the field.**

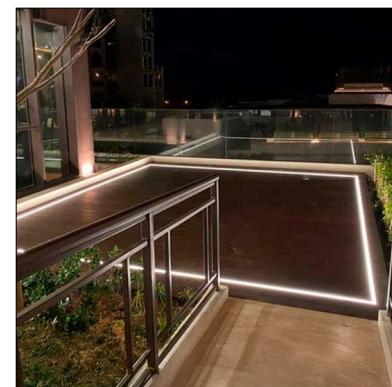

**NOTE:** Client should submit detailed dimension drawing for each project.

**NOT CUTTABLE IN THE FIELD**

## TECHNICAL DATA

<b>Wattage</b>	22W per 3.3 ft (1m) - Static White 12W per 3.3 ft (1m) - Tunable White 15W per 3.3 ft (1m) - RGB 18W per 3.3 ft (1m) - RGBW
<b>Power Supply</b>	Remote 24VDC, not included. See page 2.
<b>Construction</b>	Body: AISI 316L Stainless Steel Lens / Diffuser: Opal Polyurethane Resin Cable Length: 3.28' included
<b>CCT</b>	2200K, 2700K, 3000K, 3500K, 4000K, 4500K, 5500K, Tunable: 2900K-5900K, RGB, RGBW
<b>CRI</b>	>90 (Static, Tunable); 80 (RGB, RGBW)
<b>Delivered Lumens</b>	790 lm / 3.28' (3500K) 780 lm / 3.28' (Tunable White) 375 lm / 3.28' (RGB) 450 lm / 3.28' (RGBW)
<b>Efficacy</b>	35.9 lm/W per 3.28' (3000K) 65.0 lm/W per 3.28' (Tunable White) 25.0 lm/W per 3.28' (RGB) 25.0 lm/W per 3.28' (RGBW)
<b>Optics</b>	Diffuse
<b>Fixture Dimensions</b>	1.02" x 1.26" h x Various Lengths (max 9.5 ft)
<b>LED Source</b>	SMD 3014 SHINEON - Static, Tunable SMD 5050 PROLIGHT - RGB, RGBW
<b>LED Spacing</b>	408 LED per 3.28 ft (1 m)
<b>Lumen Maintenance</b>	L80, B10>50,000 hrs
<b>Color Consistency</b>	3-Step MacAdam
<b>Operating Temp</b>	-22°F to 131°F
<b>IP Rating</b>	IP68
<b>Impact Resistance</b>	IK10

## ORDERING INFORMATION

Example: L704X-2x10.V5.24.68.F.US. Power Supplies / Accessories ordered separately.

L704X	-		.	24	.	68	.	F	.	US
<b>Model No.</b>	<b>CCT</b>			<b>Power</b>		<b>IP Rating</b>				
L704X - Drive Line	2x10.V8 - 2200K	2x10.W5 - 4500K		24 - 24VDC		68 - IP68		F		US
<b>NOTE:</b> Client should submit detailed dimension drawing for each project.	2x10.V2 - 2700K	2x10.N - 5500K								
	2x10.V5 - 3000K	TW2 - 2900K-5400K								
	2x10.V - 3500K	RGB4 - RGB								
	2x10.W - 4000K	RGB4W - RGBW								

Job Name/Date:

Fixture Type Designation:

## SUGGESTED POWER SUPPLIES

24VDC - **TO BE USED WITH FOUNTAIN / SWIMMING POOLS**

Part Number	Description	Input/Output	# of Fixtures
<a href="#">FPV-100100024</a>	0-10V Dimming (2 Channels)	120-277VAC to 24VDC, 100W, Class 2, NEMA 4	1 every 10 ft

## SUGGESTED POWER SUPPLIES

24VDC - **TO BE USE FOR INDOOR/OUTDOOR USE - NOT** Fountain / Swimming Pool



PPLT00715

Part Number	Description	Input/Output	# of Fixtures
<a href="#">PPLT00715</a>	ELV / TRIAC / 0-10V Dimming	120-277VAC to 24VDC, 96W, Class 2, WET/DAMP	1 every 10 ft

## ACCESSORIES - Cable Type

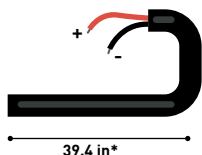

**SP-CA-68-2-1** (Static White)

Water immersion / Outdoor power cable  
IP68, Black (2x0.50mm2+ n. 2 Kevlar wires)  
External Ø0.21".

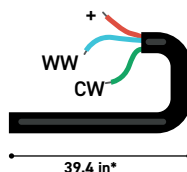

**SP-CA-68-4-1** (Tunable White)

Water immersion / Outdoor power cable  
IP68, Black (4x0.50mm2+ n. 2 Kevlar wires)  
External Ø0.23".

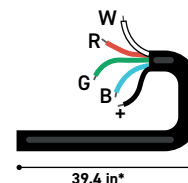

**SP-CA-68-5-1** (RGBW)

Water immersion / Outdoor power cable  
IP68, Black (5x0.50mm2+ n. 2 Kevlar wires)  
External Ø0.24".

## ACCESSORIES - Installation

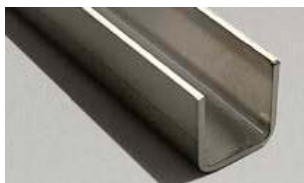

**L704X-GF**

AISI 316 L steel outercase 1.2" x 1.3"  
for L704X drive over model

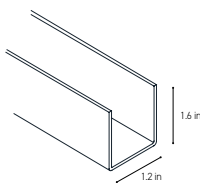

**L704-GF**

ABS mounting outercase  
for L704X walkable model

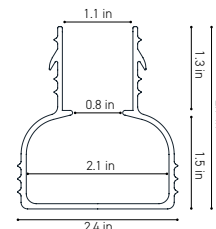

Job Name/Date:

Fixture Type Designation:

## ACCESSORIES - Installation

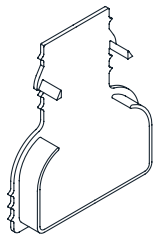

### L704-GF-TP

Pair of caps  
or L704 ABS walkable outer case

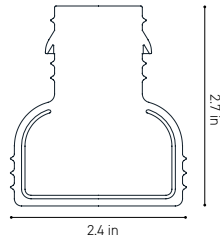

### L704-GF-OR

Linear joint  
or L704 ABS walkable outer case

## INSTALLATION - Composition Example

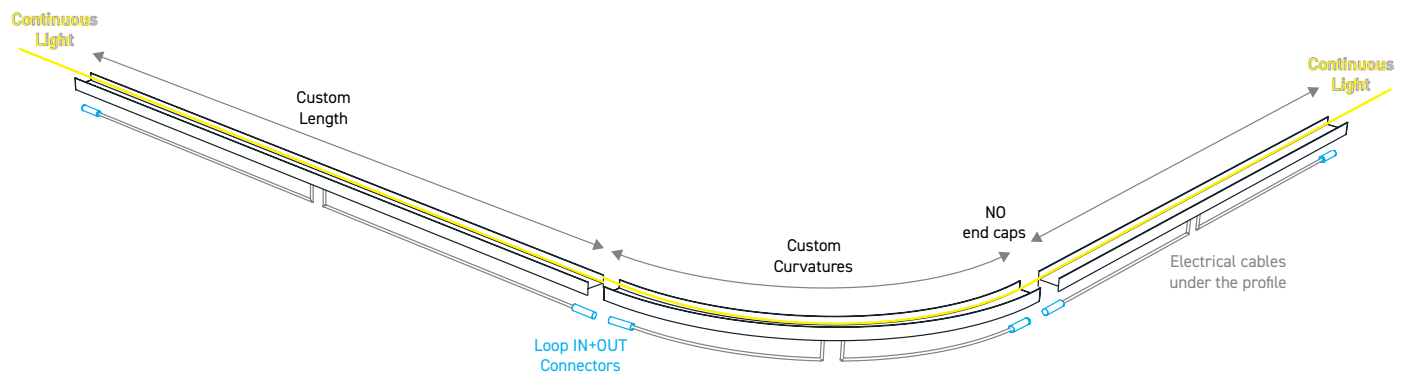

## PHOTOMETRIC DATA

Comign Soon

Job Name/Date:

Fixture Type Designation: