

UBICA is a family of IP65-rated, stainless steel fixtures with a cube shape, suitable for wall, ceiling, suspension, or floor mounting installation. They offer diffuse illumination or blade of light for architectural accent solutions, and are available in 3 color temperatures and 3 standard Hard Coat Treatment finishes. UBICA P-30 is the pendant version.

TECHNICAL DATA

Wattage	2W
Power Supply	Remote 700mA, not included. See page 2
Construction	Body: AISI 316L Stainless Steel Lens: Polycarbonate
CCT	2700K, 3000K, 4000K
CRI	80
Delivered Lumens	279 lm (3000K)
Efficacy	139.5 lm/W (3000K)
Optics	Wide
Lumen Maintenance	L80, B10 @100.000h Ta=25°C
Hard Coat Finishes	Inox Natural, Inox Graphite, Inox Bronze
Fixture Dimensions	1.18" l x 1.18" w x 1.18" h
IP Rating	IP65
Impact Resistance	IK08
Warranty	2 Years Extendable to 5 Years

Hard Coating Treatment is the surface treatment of all the products by Stral Lighting. It is not a skin of color, but instead is a process that allows for the color to be absorbed all the way through. If a product is scratched, the color beneath is the same as the color on the surface. It guarantees a high superficial resistance to corrosion and atmospheric agents, as well as making the products anti-fingerprint and anti-stain. Available in three finishes Inox Natural, Inox Graphite and Inox Bronze.

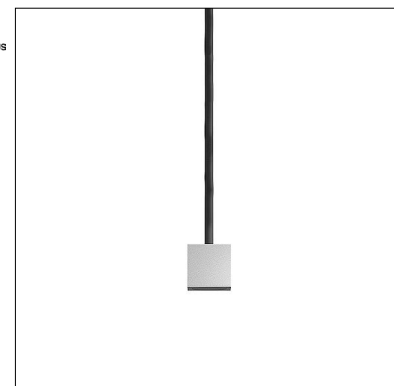

Fixture Dimensions



1.18



1.18

ORDERING INFORMATION

Example: SPT9011024B.US. Power Supplies / Accessories ordered separately.

SPT90110		4		.US
Model No.	CCT	Optics	Finishes	
SPT90110	2 - 2700K 3 - 3000K 4 - 4000K	4 - Wide	N - Inox Natural G - Inox Graphite B - Inox Bronze	.US

Job Name/Date:

Fixture Type Designation:

SUGGESTED POWER SUPPLIES

700mA

Part Number	Description	Input/Output	# of Fixtures
PPLT00537	Non-Dim	120-277VAC to 700mA, 4W, Class 2	1-1
PPLT00498	Phase Dim (120V only)	120VAC to 700mA, 12W, Class 2	1-2
PPLT00261	Leading / Trailing Edge Dimming to 10% (120V only)	120-277VAC to 700mA, 32W, Class 2	7-15
PPLT00467-P	0-10V Dimming to 1.0%	120-277VAC to 700mA, 50W, Class 2, DAMP	1-18
PPLT00561-P	0-10V Dimming to 0.1%	120-277VAC to 700mA, 100W, Class 2	2-18

Suggested Lutron Compatible

Part Number	Option	Lutron SKU	Dim Range	Description	Input/Output	# of Fixtures
PPLT00515	L3DAE / L3DA3W	L3DA	100%-1%	Hi-Lume™ 1% EcoSystem™ or 1% 3-Wire LED Driver	120-277VAC to 700mA, 14W, Class 2	3-6
PPLT00635	PEQ0E	PEQ0	100%-0.1%	Hi-Lume Premier 0.1% EcoSystem™ LED Driver F2B	120-277VAC to 700mA, 20W, Class 2	4-9
PPLT00181	L3DAE / L3DA3W	L3DA	100%-1%	Hi-Lume™ 1% EcoSystem™ or 1% 3-Wire LED Driver	120-277VAC to 700mA, 38W, Class 2	11-17

For other power supply options consult factory.

ACCESSORIES - Installation

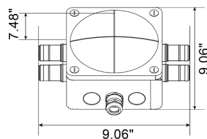
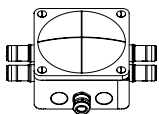

PT41000

Power Box for 4 Devices
4 x 3W

PHOTOMETRIC DATA

NOTE: All photometry is 3000K

Maximum Candela = 38.7

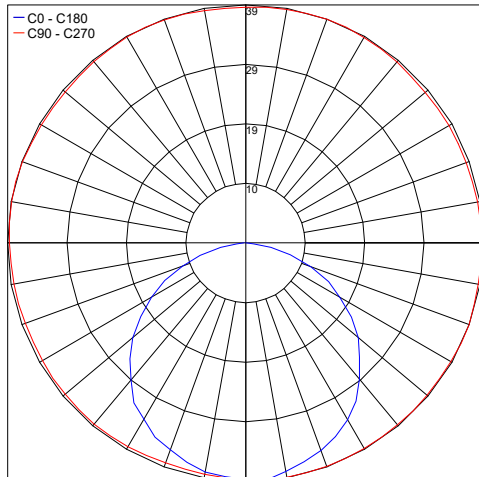

PHOTOMETRIC FILENAME : UBICA 3000K NATURAL - PT9011034N.IES

Job Name/Date:

Fixture Type Designation: