

Minnie is a miniature, adjustable surface mounted luminaire that can be installed on ceilings or walls. It is less than 1-inch in diameter, and available in 3 static white color temperatures and 4 standard finishes.



## TECHNICAL DATA

<b>Wattage</b>	4W
<b>Power Supply.</b>	Remote 220mA, not included. See page 2
<b>Construction</b>	Body: Aluminum Lens: Glass
<b>CCT</b>	3000K
<b>CRI</b>	>90
<b>Delivered Lumens</b>	424 lm (3000K, 25°)
<b>Efficacy</b>	84.8 lm/W
<b>Optics</b>	25°, 50°
<b>LED Source</b>	BRIDGELUX GEN8 COB LED
<b>Finishes</b>	4 Standard, Custom RAL on request
<b>Fixture Dimensions</b>	Ø0.91" x 2.48" h Base: Ø2.0"
<b>IP Rating</b>	IP67

Fixture Dimensions

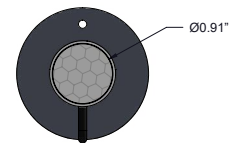
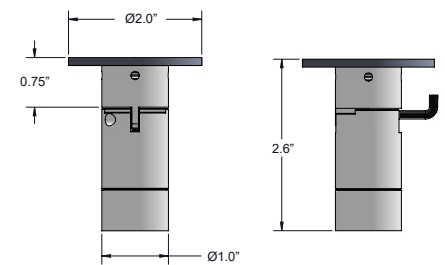

## ORDERING INFORMATION

Example: MIN-L-30-96-25-H-R-0. Power Supplies ordered separately.

<b>MIN-L</b>	-	<b>30</b>	-		-		-	<b>R</b>	-	<b>0</b>	
<b>Model #</b>	<b>CCT</b>	<b>Finish</b>	<b>Optics</b>	<b>Lens</b>	<b>Dimming / Driver</b>	<b>Options</b>					
MIN-L	30 - 3000K	11 - White Suede 97 - Black Anodized 96 - Silver Anodized PN - Polished Nickel C - Custom	25 - 25° 50 - 50°	H - Clear w/ Honeycomb C - Clear L - Linear	R - <u>Remote</u> Driver (Static White, Dim to Warm, RGBW)	0 - None					

Job Name/Date:

Fixture Type Designation:

## SUGGESTED POWER SUPPLIES

Static White - 220mA

Part Number	Description	Input/Output	# of Fixtures
<a href="#">PPLT00466-P</a>	0-10V Dimming to 1.0%	120-277VAC to 220mA, 10W, Class 2, DAMP	1-2
<a href="#">PPLT00309-P</a>	0-10V Dimming to 0.1%	120-277VAC to 220mA, 50W, Class 2, DAMP	1-3
<a href="#">PPLT00467-P</a>	0-10V Dimming to 1.0%	120-277VAC to 220mA, 50W, Class 2, DAMP	1-3

For other power supply options consult factory.

## PHOTOMETRIC DATA

Note: Photometry is 3000K

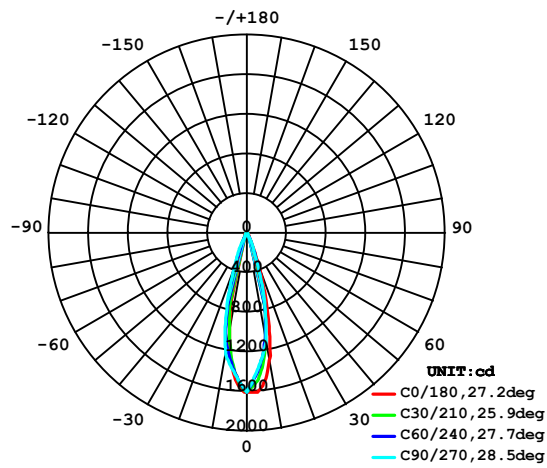

AVERAGE BEAM ANGLE (50%) : 27.3 DEG

Job Name/Date:

Fixture Type Designation: