

The Centaur C4D is a 4" diameter in-grade uplight with a Ø2.5" aperture, made of stainless steel that is suitable for power washing and is driveover rated up to 11,000 lbs.

TECHNICAL DATA

Wattage	9W
Power Supply	Integral 120-277VAC
Dimming	0-10V
Construction	Body and Trim: Stainless Steel 304 Alloy Jbox: Cast Stainless Steel Lens: 0.4" Tempered Glass Lens Frame: Threaded Bottlecap
CCT	3000K, 4000K
CRI	>80
Delivered Lumens	270 lm (9W, 6°, 3000K) 224 lm (9W, 6°x25°, 3000K)
Efficacy	30 lm/W (9W, 6°, 3000K) 25 lm/W (9W, 6°x25°, 3000K)
Optics	None, 6°, 25°, 6°x25°
Finishes	Stainless Steel 304 Alloy
Fixture Dimensions	Ø4.0" x 4.0" h - Full Length 9.5"
Aperture	Ø2.5"
LED Source	LED
IP Rating	IP68, IP69
Driveover Rating	11,000 lbs



Fixture Dimensions

Ø4.0" x 4.0" h

See Full Drawing on page 2

ORDERING INFORMATION

Example: C4D-L-930-4-SS-1-C-T-0. Accessories ordered separately.

C4D-L	-		-	4	-	SS	-		-	C	-		-	0
-------	---	--	---	---	---	----	---	--	---	---	---	--	---	---

Model #	Watts/CCT	Body	Finish	Optics	Driver	Lens	Options
C4D-L	930 - 9W, 3000K 940 - 9W, 4000K	4 - Recessed box with conduit entries	SS - Stainless Steel	1 - 6° 3 - 25° 4 - 6°x25° Elliptical 0 - None Note: Optic options 1, 3 and 4 can only be used with "T" lens. Optic 0 (None) can be used with any of the others.	C - Integral 120-277VAC 0-10V	T - Clear Tempered Glass G - Frosted Tempered Glass K - Flash White BTM & Clear Top J - Flash White BTM & Non-Skid Top Pattern Q - Non-Skid Patterned Tempered Glass Note: Optic options 1, 3 and 4 can only be used with "T" lens. Optic 0 (None) can be used with any of the others.	0 - None H - Honeycomb Louver A - Anti-Glare Shield Note: Rubber Lens Holder PP600167 included w/ options

Job Name/Date:

Fixture Type Designation:

FIXTURE DIMENSIONS

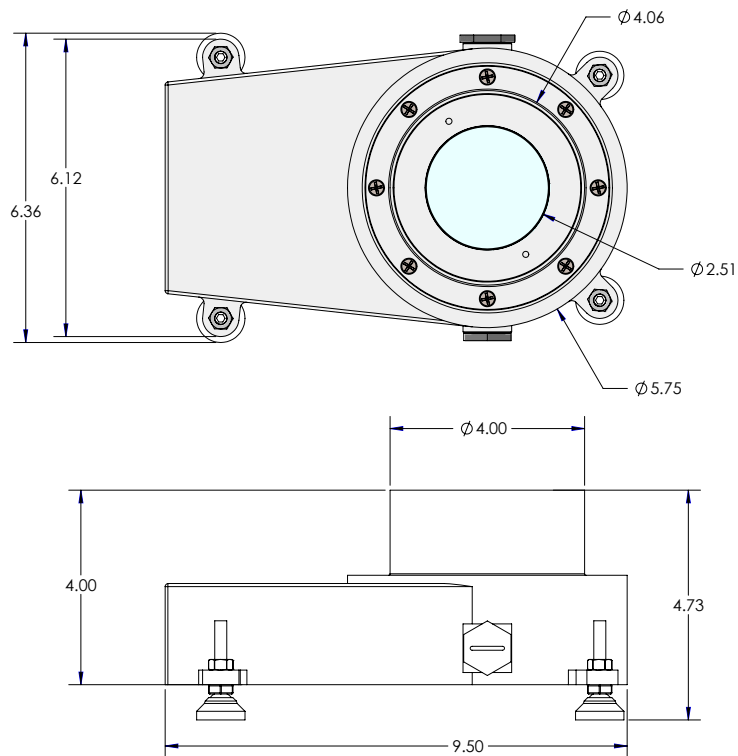

ACCESSORIES

Installation



LL301 - Optional
Leveling Pad
Set of 4

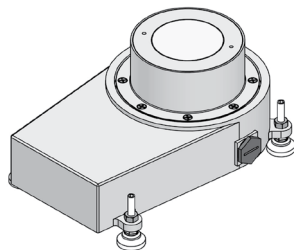

Anti-Glare

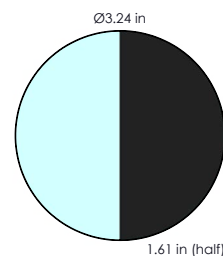

PPDG0059001*
Anti-Glare Shield
*include as an option
in ordering matrix

Job Name/Date:

Fixture Type Designation: