

Genius Kelvin is a small and powerful recessed LED downlight, with an aperture less than 1" in diameter, offered in color temperatures other than the normal Genius (2200K, 2700K, 3500K). Easy access to LED module via a unique spring loaded mechanism. JA8-2016 Certified and can be used in IC, Chicago Plenum ceilings.

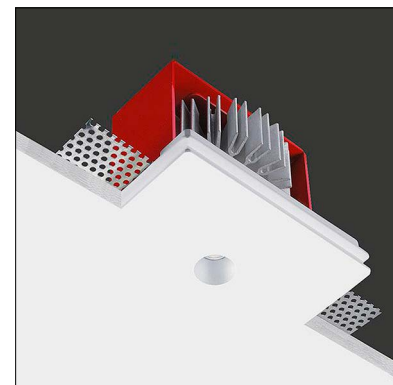

TECHNICAL DATA

Wattage / Input	6W (350mA)
Power Supply	Remote, not included. See page 2
Construction	Body: AirCoral® Frame: Steel Aluminum Heat Sink
CCT	2200K, 2400K, 3500K
CRI	>90
Lumen Output	910 lm (3500K)
Efficacy	71.3 lm/W
Optics	24°, 40°
Finishes	Unfinished
Cut-Out Dimensions	5.31" x 4.33"
Fixture Dimensions	4.92" x 3.94" x 5.31" h
Aperture	Ø0.79"
Fixture Weight	1.76 lbs
LED Source	1 COB LED Removalable Cartridge
IP Rating	IP20
JA8	Certified

The body is made of AirCoral® a unique patented composite material that actually purifies the air. It can be calculated how many cubic feet each fixture will purify. See website for AirCoral® calculator.

Additionally, AirCoral® is:

- Antibacterial.
- Antifungal.
- Scratch-resistant.
- Dust-resistant.
- Suitable for painting.
- LEED recognized material.

Ceiling Cut-Out: 5.31" x 4.33"
Fixture Dimensions:

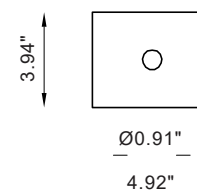
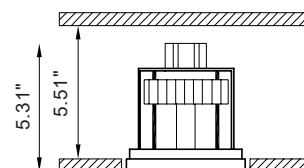

ORDERING INFORMATION

Example: BU1874.AC.4R40M.35.WD.US. Accessories / Power Supplies ordered separately.

BU1874	AC			WD.US
Model No.	Material	Optics	CCT	
BU1874	AC - AirCoral®	4R24M - 24° 4R40M - 40°	22 - 2200K 24 - 2400K 35 - 3500K	WD.US

Job Name/Date:

Fixture Type Designation:

SUGGESTED POWER SUPPLIES

JA8 Compatible (Also for General Use)

Part Number	Description	Input/Output	# of Fixtures
PPLT00466-P	0-10V Dimming to 1.0%	120-277VAC to 350mA, 10W, Class 2, DAMP	1 - 1

SUGGESTED POWER SUPPLIES

350mA (Not JA8 Compatible)

Part Number	Description	Input/Output	# of Fixtures
PPLT00498	Phase Dim (120V only)	120VAC to 350mA, 12W, Class 2, DAMP	1 - 1
PPLT00465-P	0-10V Dimming to 1.0%	120-277VAC to 350mA, 20W, Class 2, DAMP	1 - 2
PPLT00309-P	0-10V Dimming to 0.1%	120-277VAC to 350mA, 50W, Class 2, DAMP	1 - 2
PPLT00561-P	0-10V Dimming to 0.1%	120-277VAC to 350mA, 50W, Class 2	1 - 3

Suggested Lutron Compatible (Not JA8 Compatible)

Part Number	Option	Lutron SKU	Dim Range	Description	Input/Output	# of Fixtures
PPLT00247	L3DAE / L3DA3W	L3DA	100%-1%	Hi-lume™ 1% EcoSystem™ / 1% 3-Wire LED Driver	120-277VAC to 350mA, 7W	1-1
PPLT00516	L3DAE / L3DA3W	L3DA	100%-1%	Hi-lume™ 1% EcoSystem™ / 1% 3-Wire LED Driver	120-277VAC to 350mA, 13W	1-2

For other power supply options consult factory.

ACCESSORIES - Installation

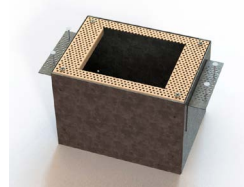

BR1874 - ____

Back Box

Include one of the below options:

LT - IC Rated / JA8 Rated

LT-C - Chicago Plenum

PHOTOMETRIC DATA

Coming Soon

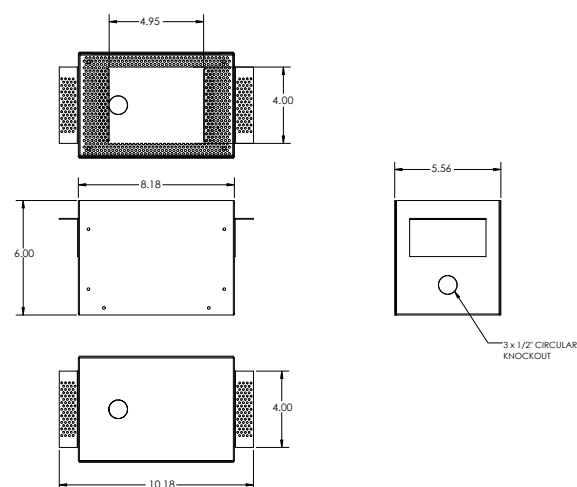

Job Name/Date:

Fixture Type Designation:

Job Name/Date:

Fixture Type Designation: