

Klimpt Wood is an LED bollard based on the Klimpt bollard suitable for outdoor installation. It has with a 4.5" square head and real teak wood inset in the aluminum body. Offered in 2 heights – 2-foot or 3-foot – with 3 static white color temperatures, 3 optics options, and 5 standard finishes. Dark Sky compliant.



MADE IN THE U.S.A. - Teak Wood Shown

TECHNICAL DATA

Wattage	20W
Power Supply	Integral 120VAC
Dimming	0-10V Dimming
Construction	Body: Aluminum Lens: Clear
CCT	2700K, 3000K, 4000K
BUG Rating	B1-U0-G0 (3000K - All Optics)
CRI	>90
Delivered Lumens	1428 lm (24°, 3000K) 1356 lm (36°, 3000K) 1565 lm (Asym, 3000K) Dark Sky compliant
Efficacy	71.4 lm/W (24°, 3000K) 67.8 lm/W (36°, 3000K) 78.3 lm/W (Asym, 3000K)
Optics	24°, 36°, Asymmetric
Finishes	Real Teak Wood 5 Standard - See page 2 Custom RAL on request
Fixture Dimensions	Pole: 2.56" l x 2.20" w x 24.0" or 36.0" h Head: 4.48" x 4.48" x 1.42" h
IP Rating	IP65

Fixture Dimensions

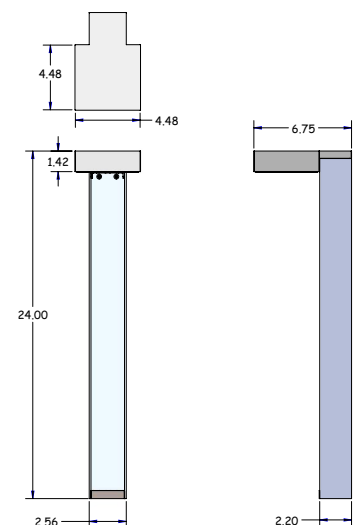

ORDERING INFORMATION

Example: KLI-W-1-30-01-TK-11-C-0. Accessories ordered separately.

KLI-W	-		-		-	TK	-		-	C	-	0
Model #	Height	CCT	Optics	Wood Finish	Finish	Dimming	Options					
KLI-W	1 - 2 ft 2 - 3 ft	27 - 2700K 30 - 3000K 40 - 4000K	01 - 24° 02 - 36° 03 - Asym.	TK - Real Teak Wood	11 - White Suede 02 - Black Suede 03 - Gray 18 - Textured Bronze TS - Silver C - Custom	C - Integral 120VAC 0-10V Dimming	0 - None					

Job Name/Date:

Fixture Type Designation:

ACCESSORIES - Installation

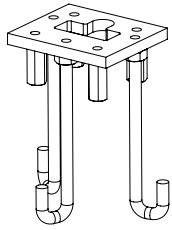

AM-00010
Mounting Base
Assembly

WOOD FINISHES - Real Teak Wood Shown on page 1

FINISHES

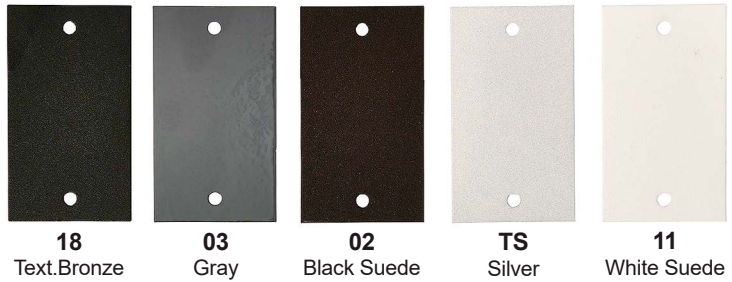

PHOTOMETRICS

Note: All photometry is 3000K

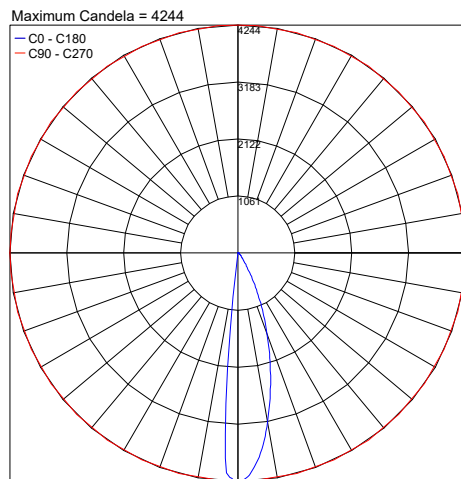

PHOTOMETRIC FILENAME : KLIMPT-KAHLO BOLLARD 24FT 30K 24° .IES

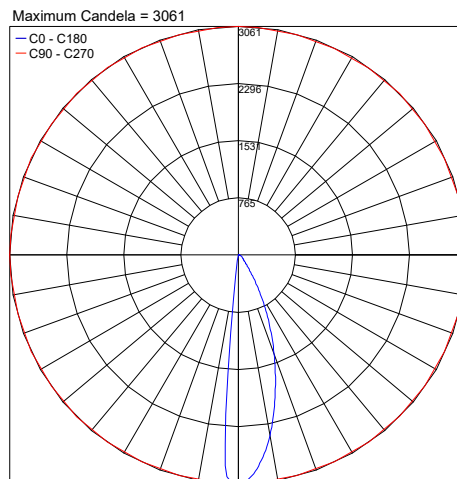

PHOTOMETRIC FILENAME : KLIMPT-KAHLO BOLLARD 24FT 30K 36° .IES

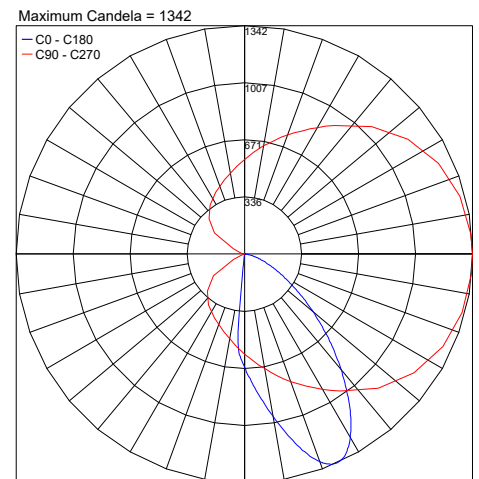

PHOTOMETRIC FILENAME : KLIMPT-KAHLO BOLLARD 24FT 30K ASYM .IES

Job Name/Date:

Fixture Type Designation: